

Dec-08/2022

4

3

2

1



B

B

NORTH STAR WINDOWS AND DOORS

PREPARING THE ROUGH OPENING



A

A

4

3

2

1



SUPPLIED COMPONENT LIST FOR KD DOOR

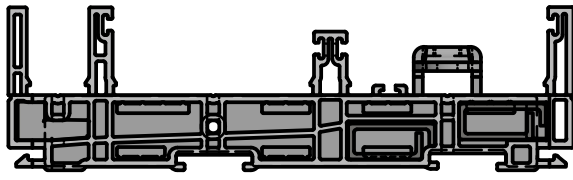
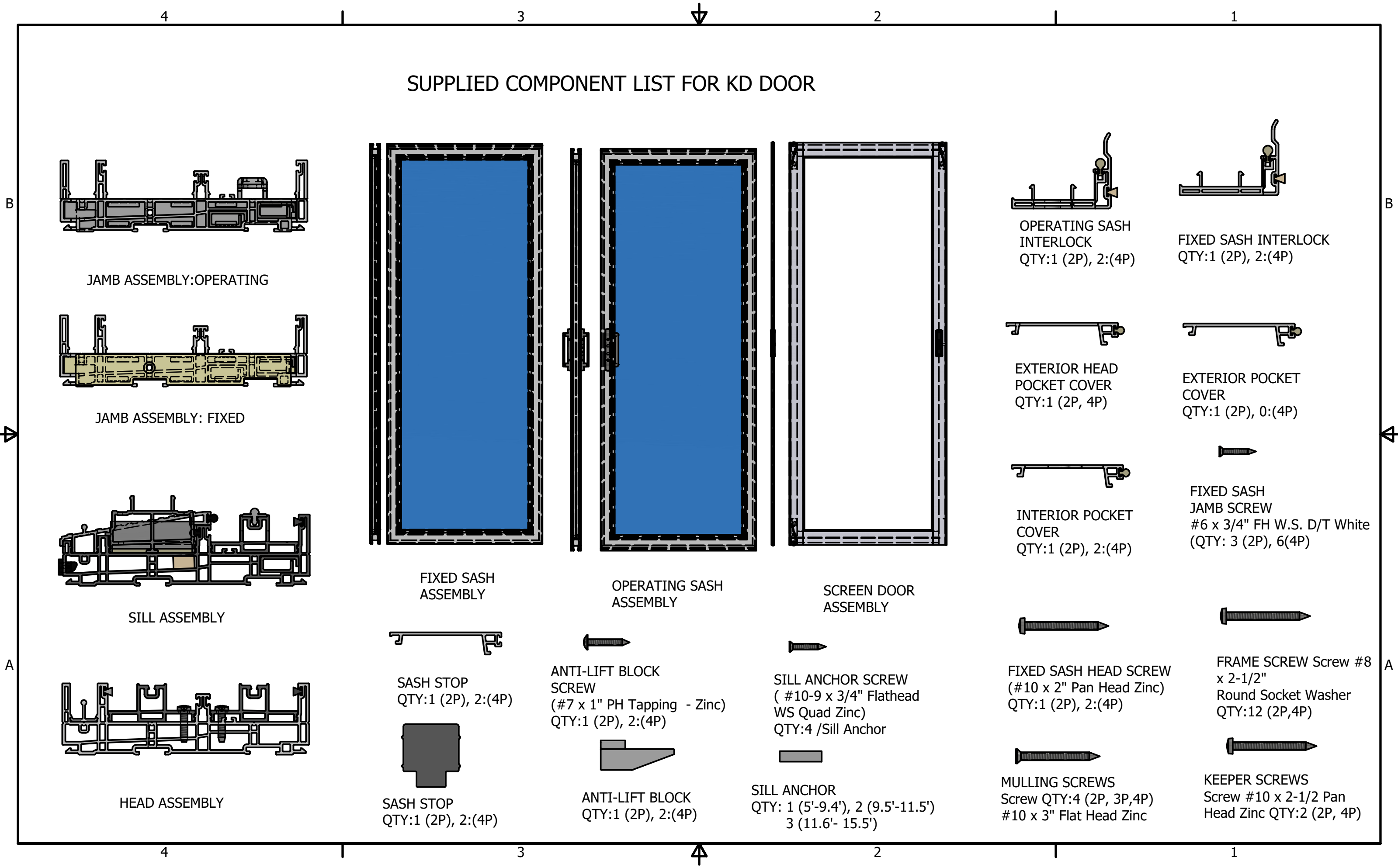

JAMB ASSEMBLY: OPERATING

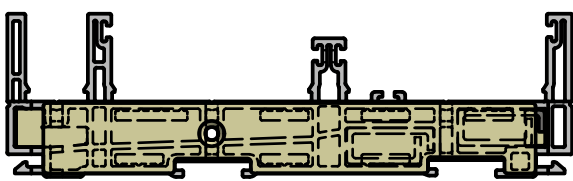

JAMB ASSEMBLY: FIXED

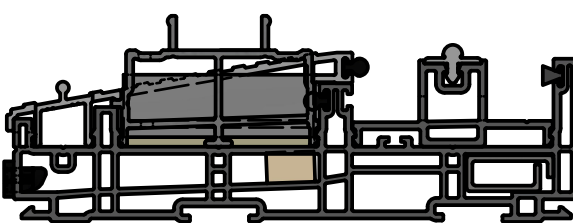

SILL ASSEMBLY

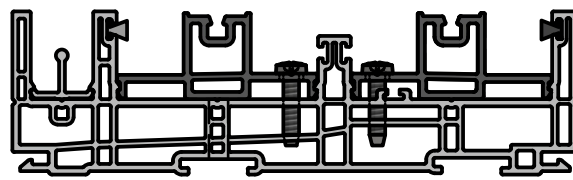

HEAD ASSEMBLY

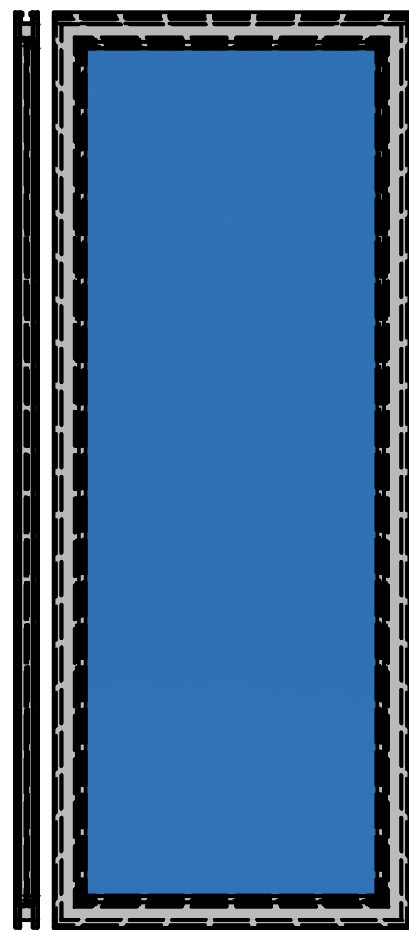

FIXED SASH ASSEMBLY

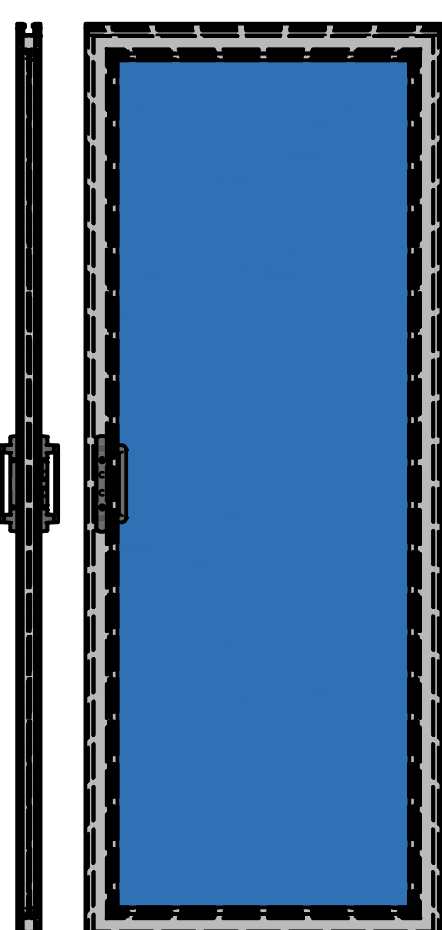

OPERATING SASH ASSEMBLY

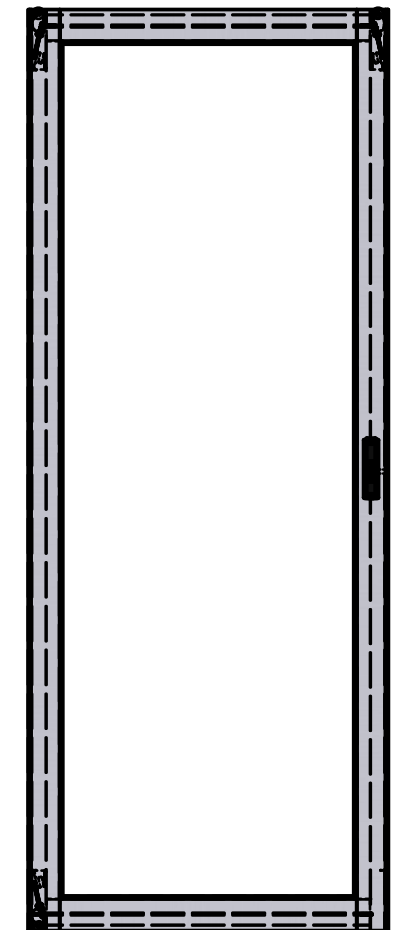

SCREEN DOOR ASSEMBLY

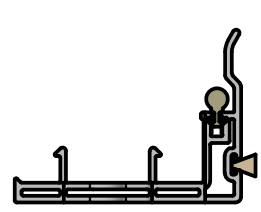

OPERATING SASH INTERLOCK  
QTY:1 (2P), 2:(4P)

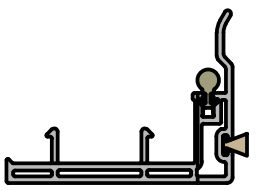

FIXED SASH INTERLOCK  
QTY:1 (2P), 2:(4P)



EXTERIOR HEAD POCKET COVER  
QTY:1 (2P, 4P)



EXTERIOR POCKET COVER  
QTY:1 (2P), 0:(4P)



INTERIOR POCKET COVER  
QTY:1 (2P), 2:(4P)



FIXED SASH JAMB SCREW  
#6 x 3/4" FH W.S. D/T White  
(QTY: 3 (2P), 6(4P))



FIXED SASH HEAD SCREW  
(#10 x 2" Pan Head Zinc)  
QTY:1 (2P), 2:(4P)



FRAME SCREW Screw #8 x 2-1/2" Round Socket Washer  
QTY:12 (2P,4P)



MULLING SCREWS  
Screw QTY:4 (2P, 3P,4P)  
#10 x 3" Flat Head Zinc



KEEPER SCREWS  
Screw #10 x 2-1/2 Pan Head Zinc QTY:2 (2P, 4P)



SASH STOP  
QTY:1 (2P), 2:(4P)



ANTI-LIFT BLOCK SCREW  
(#7 x 1" PH Tapping - Zinc)  
QTY:1 (2P), 2:(4P)



SILL ANCHOR SCREW  
( #10-9 x 3/4" Flathead WS Quad Zinc)  
QTY:4 /Sill Anchor



ANTI-LIFT BLOCK  
QTY:1 (2P), 2:(4P)



SILL ANCHOR  
QTY: 1 (5'-9.4'), 2 (9.5'-11.5')  
3 (11.6'- 15.5')

## REQUIRED TOOL LIST:

1. SAFTEY GLASSES
2. SHIMS
3. TAPE MESURE
4. LEVEL
5. POWER DRILL & BITS
6. FOAM DISPENSER
7. LOW-PRESSURE THERMAL FOAM INSULATION
8. PRY BAR
9. CHISEL
10. UTILITY KNIFE
11. SHEET METAL SCISSORS (OPTIONAL)
12. FLASHING TAPE
13. 1/2" X 16" WOOD BLOCK
14. SCREWDRIVER
15. Mallet
16. INSTALLATION SCREWS
17. BACKER ROD
18. EXTERIOR GRADE SEALANT

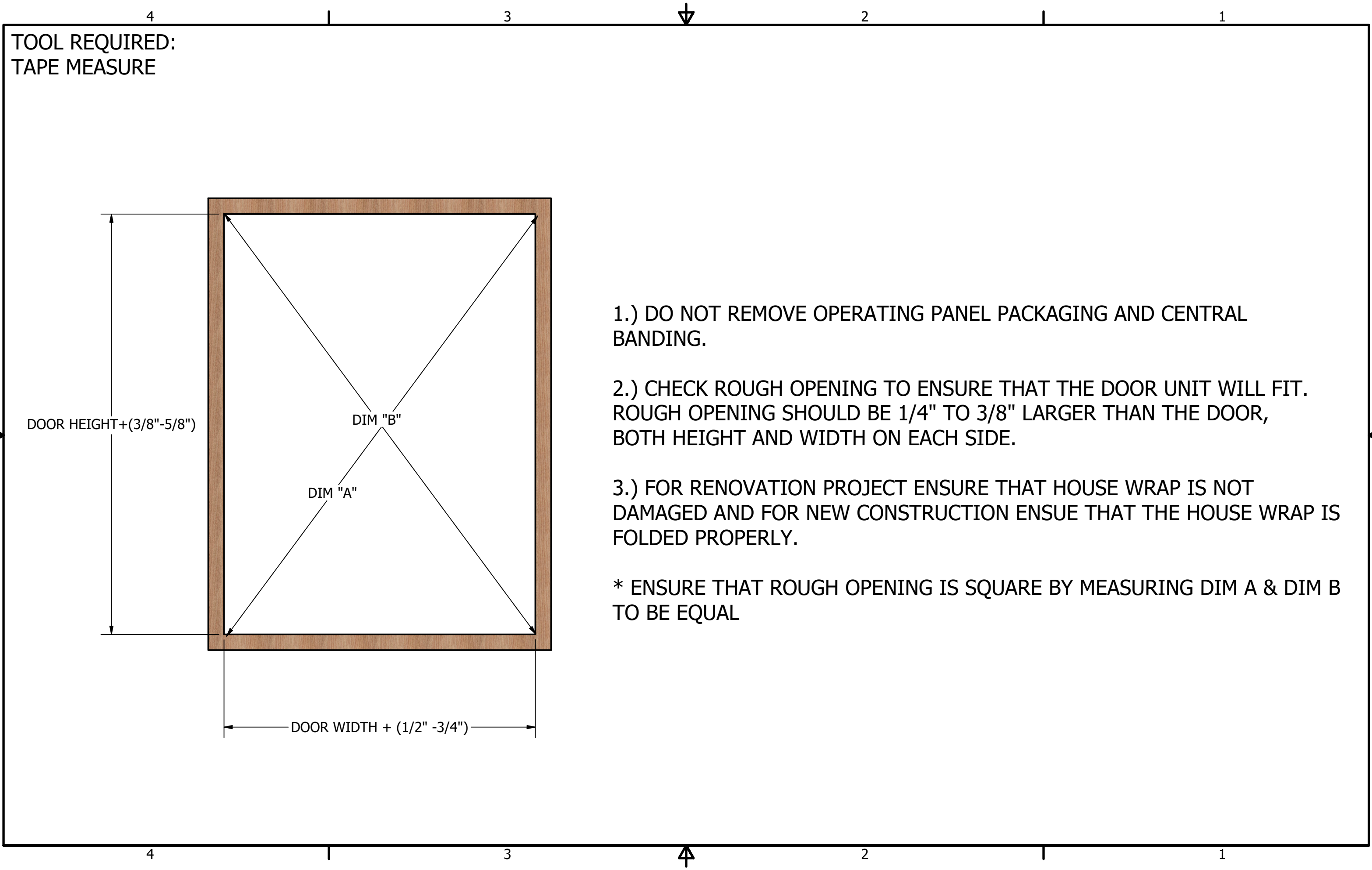

TOOL REQUIRED:  
TAPE MEASURE

- 1.) DO NOT REMOVE OPERATING PANEL PACKAGING AND CENTRAL BANDING.
  - 2.) CHECK ROUGH OPENING TO ENSURE THAT THE DOOR UNIT WILL FIT. ROUGH OPENING SHOULD BE 1/4" TO 3/8" LARGER THAN THE DOOR, BOTH HEIGHT AND WIDTH ON EACH SIDE.
  - 3.) FOR RENOVATION PROJECT ENSURE THAT HOUSE WRAP IS NOT DAMAGED AND FOR NEW CONSTRUCTION ENSUE THAT THE HOUSE WRAP IS FOLDED PROPERLY.
- \* ENSURE THAT ROUGH OPENING IS SQUARE BY MEASURING DIM A & DIM B TO BE EQUAL

TOOLS REQUIRED:  
FLASHING TAPE / SHEET METAL SCISSORS

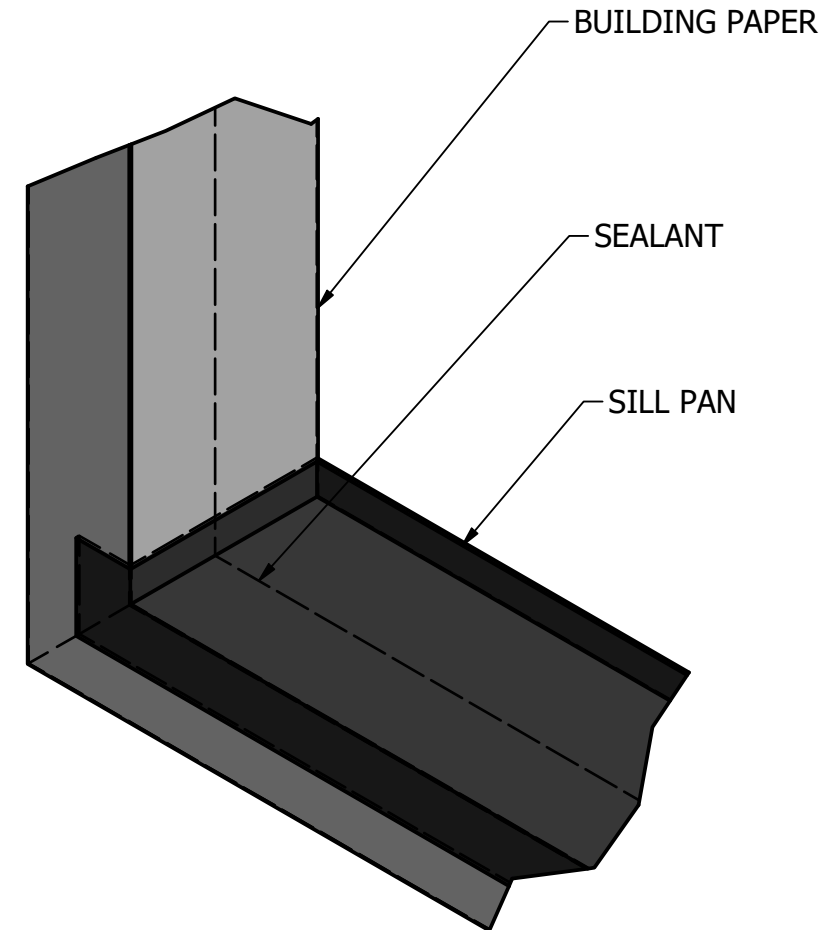
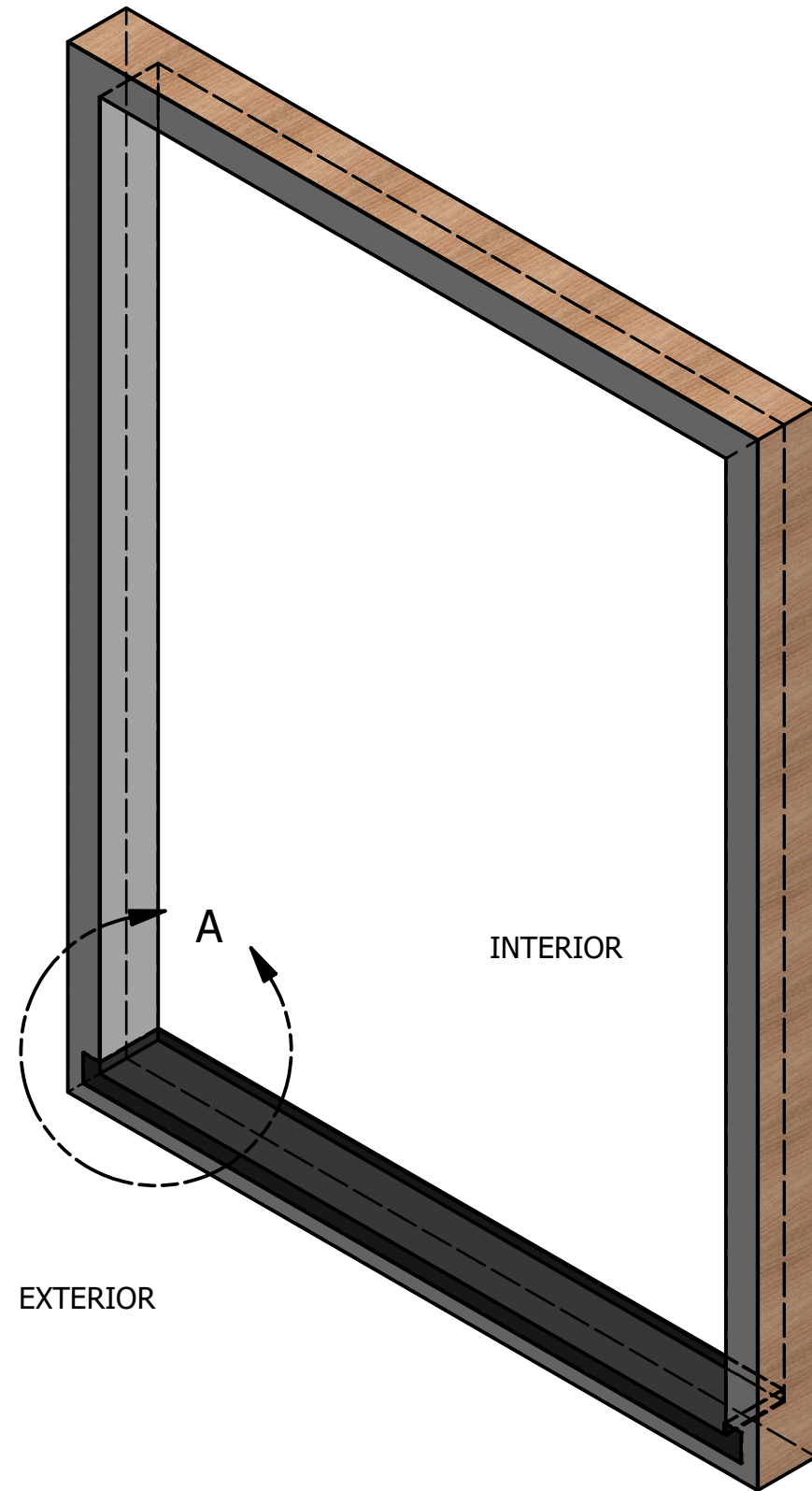

- 4.) PROPERLY FLASH THE CORNERS AND SILL OF THE RSO  
5.) OPTIONAL: INSTALL SILL PAN AS SHOWN ABOVE;  
OR USE FORMABLE FLASHING FROM THE INTERIOR

TOOLS REQUIRED:  
TAPE MEASURE, SEALANT, POWER DRILL, SCREWS

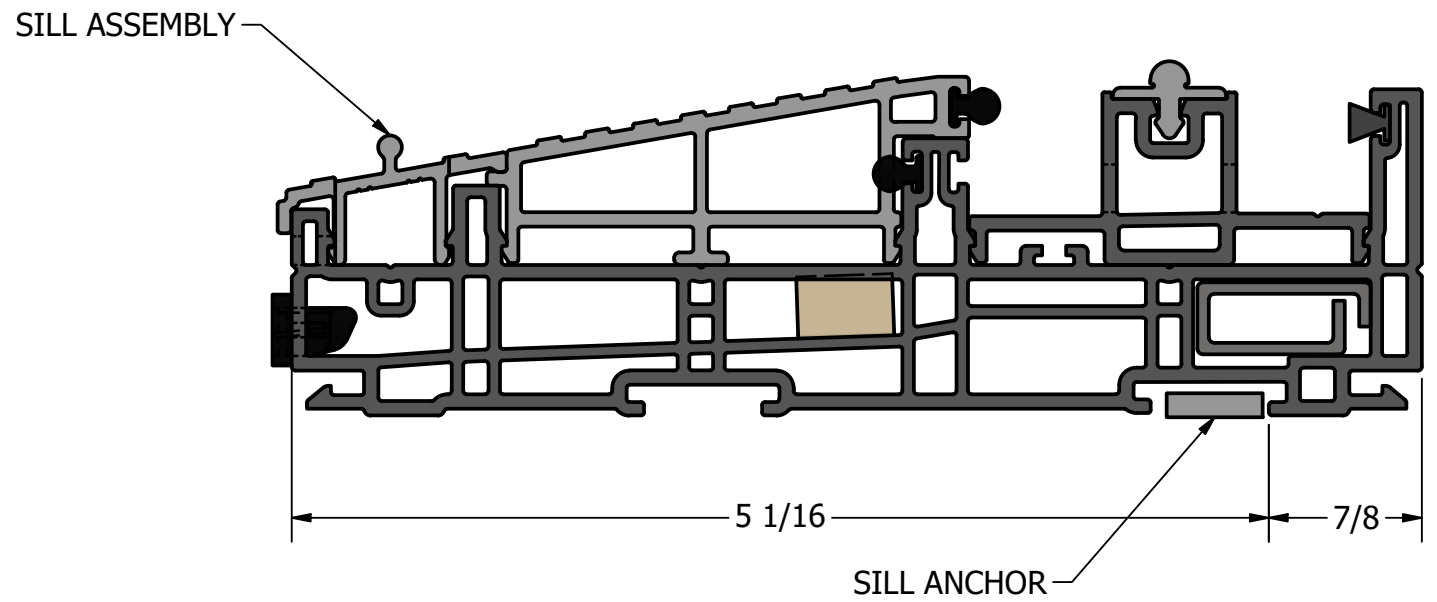
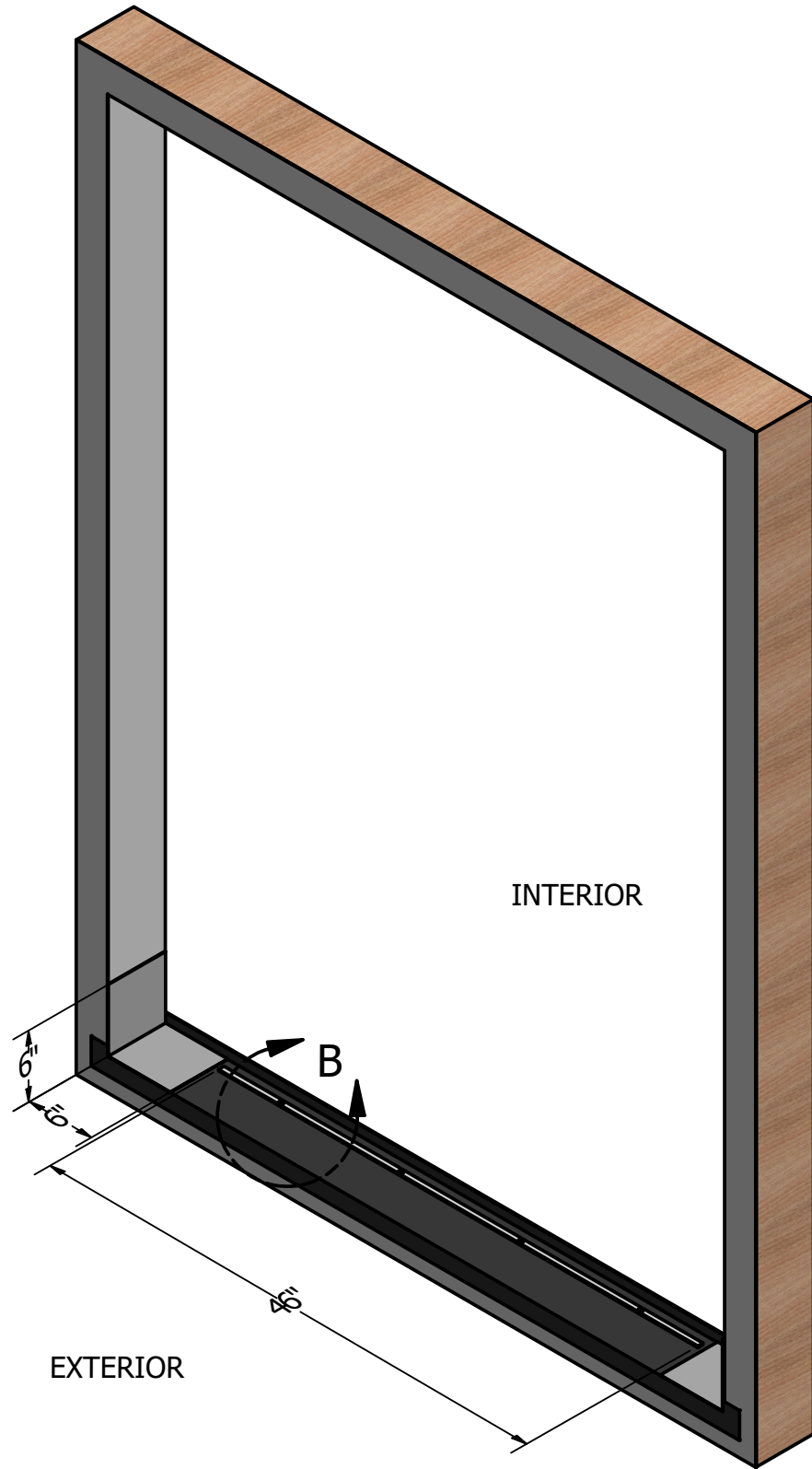

6.) USING THE INTERIOR FACE OF THE SILL ASSEMBLY (GRAY PROFILE) AS MEASURING POINT; INSTALL THE PROVIDED SILL ANCHOR 7/8" INCH TOWARD THE EXTERIOR AND IN THE CENTER OF THE DOOR.

**WARNING:** ANCHORING HAS TO BE DONE WITH FLAT HEAD SCREW AS IT IS CRITICAL THAT THE HEAD IS FLUSH WITH THE SILL ANCHOR.

7.) APPLY TWO BEADS OF SEALANTS; ONE ON TOP OF THE SILL ANCHOR, COVERING THE SCREW HEAD, AND ONE TOWARD THE EXTERIOR OF THE SILL ANCHOR. BOTH BEADS SHOULD RUN ACROSS THE ROUGH OPENING TO THE JAMBS