

Dec-09/2022

4

3

2

1

B

B

NORTH STAR WINDOWS AND DOORS

INSTALLATION OF KD DOOR
4-PANEL

A

A

4

3

2

1

4

3

2

1

SUPPLIED COMPONENT LIST FOR KD DOOR

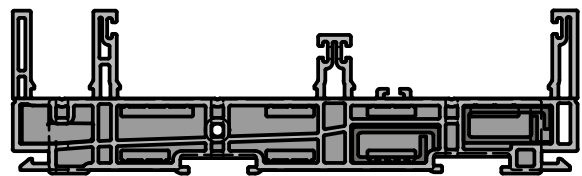

JAMB ASSEMBLY: OPERATING

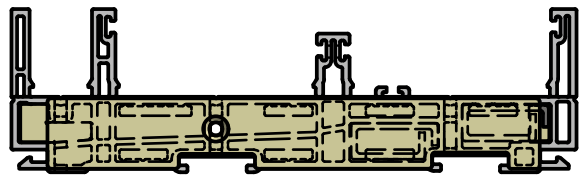

JAMB ASSEMBLY: FIXED

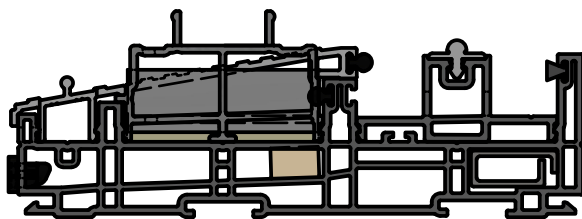

SILL ASSEMBLY

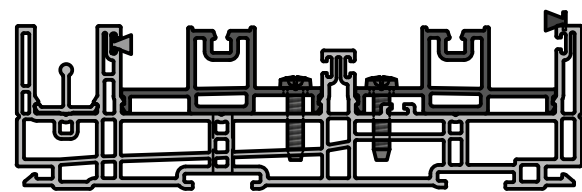

HEAD ASSEMBLY

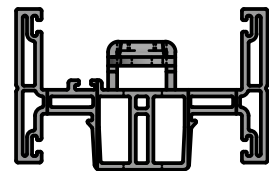

MULLION
QTY:1:(4P)

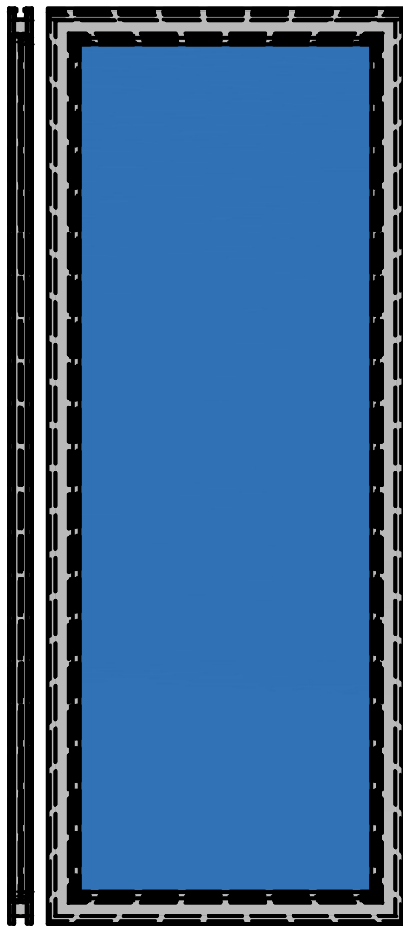

FIXED SASH
ASSEMBLY



SASH STOP
QTY:1 (2P), 2:(4P)

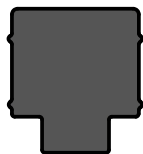

SASH STOP
QTY:1 (2P), 2:(4P)

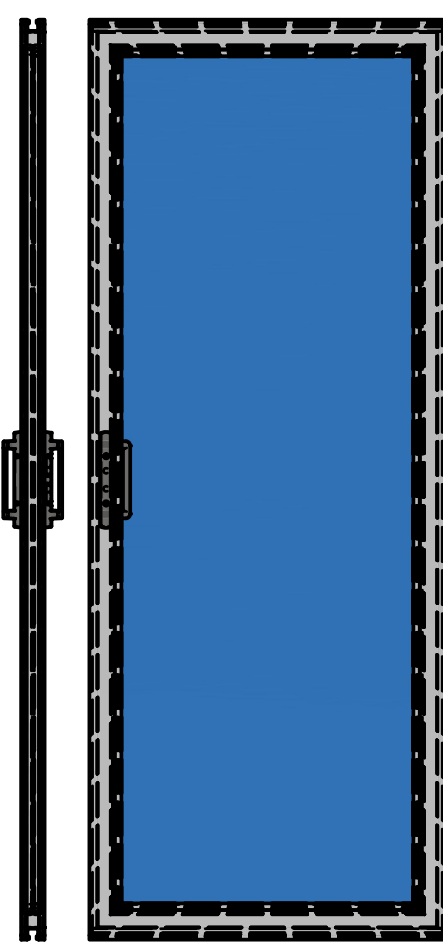

OPERATING SASH
ASSEMBLY



ANTI-LIFT BLOCK
SCREW
(#7 x 1" PH Tapping - Zinc)
QTY:1 (2P), 2:(4P)



ANTI-LIFT BLOCK
QTY:1 (2P), 2:(4P)

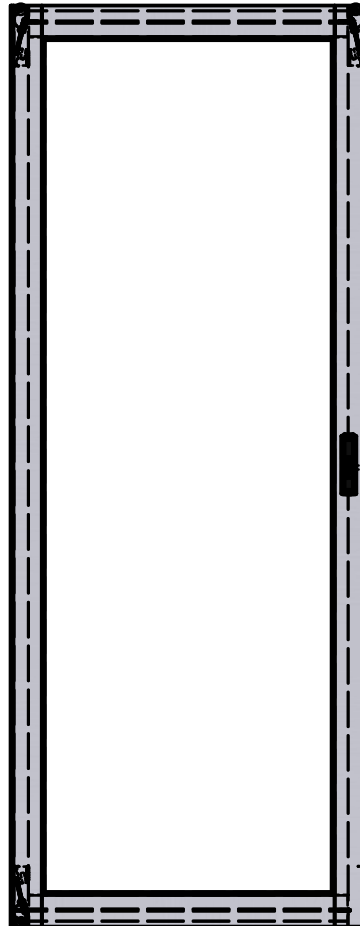

SCREEN DOOR
ASSEMBLY



SILL ANCHOR SCREW
(#10-9 x 3/4" Flathead
WS Quad Zinc)
QTY:4 /Sill Anchor



SILL ANCHOR
QTY: 1 (5'-9.4'), 2 (9.5'-11.5')
3 (11.6'- 15.5')

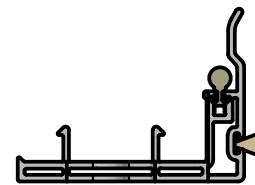

OPERATING SASH
INTERLOCK
QTY:1 (2P), 2:(4P)



EXTERIOR HEAD
POCKET COVER
QTY:1 (2P, 4P)

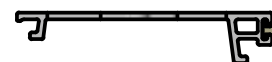

INTERIOR POCKET
COVER
QTY:1 (2P), 2:(4P)

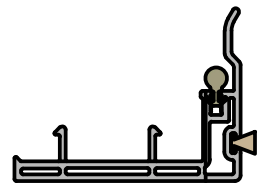

FIXED SASH INTERLOCK
QTY:1 (2P), 2:(4P)



EXTERIOR POCKET
COVER
QTY:1 (2P), 0:(4P)



FIXED SASH
JAMB SCREW
#6 x 3/4" FH W.S. D/T White
(QTY: 3 (2P), 6(4P))



FIXED SASH HEAD SCREW
(#10 x 2" Pan Head Zinc)
QTY:1 (2P), 2:(4P)



MULLING SCREWS
Screw QTY:4 (2P, 3P,4P)
#10 x 3" Flat Head Zinc



FRAME SCREW Screw #8
x 2-1/2"
Round Socket Washer
QTY:12 (2P,4P)



KEEPER SCREWS & OXO
Screw #10 x 1-1/2 Pan
Head Zinc QTY:4 (4P)

4

3

2

1

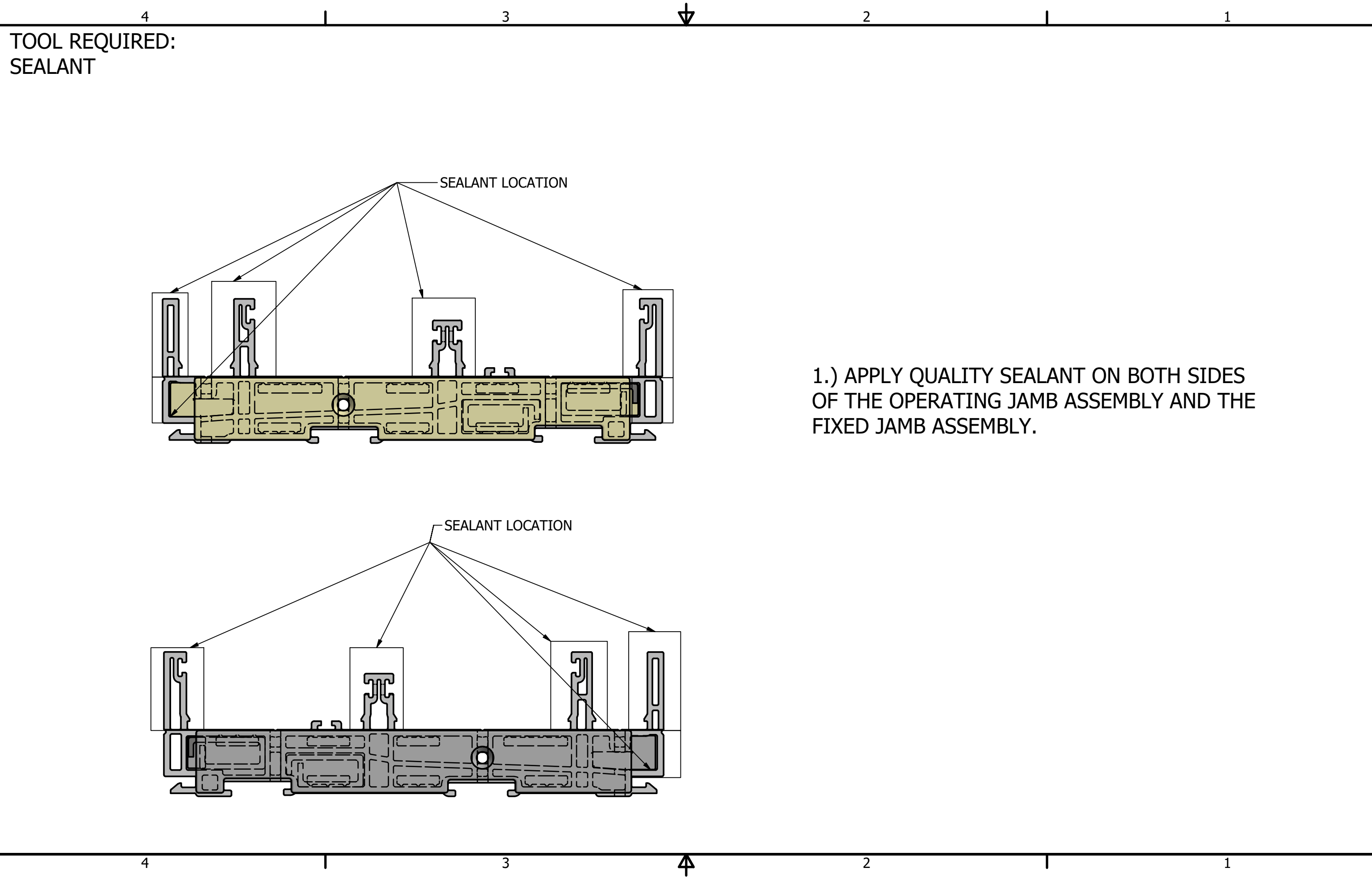

TOOL REQUIRED:
SEALANT

1.) APPLY QUALITY SEALANT ON BOTH SIDES
OF THE OPERATING JAMB ASSEMBLY AND THE
FIXED JAMB ASSEMBLY.

TOOL REQUIRED:
POWER DRILL, FRAME
SCREWS

2.) JOIN THE SILL ASSEMBLY USING 3 PAN HEAD SCREWS CAREFULLY TO NOT BOW THE EXTERIOR
GROOVE CHANNEL.

NOTE 1: WHEN MULLING A SIDE-LITE OR ADDING AN EXTERIOR ACCESSORY
(NAIL-FIN/ BRICKMOLD) CHANGE THE SCREW TO MULLING SCREW #10 x 3" Flat Head Zinc

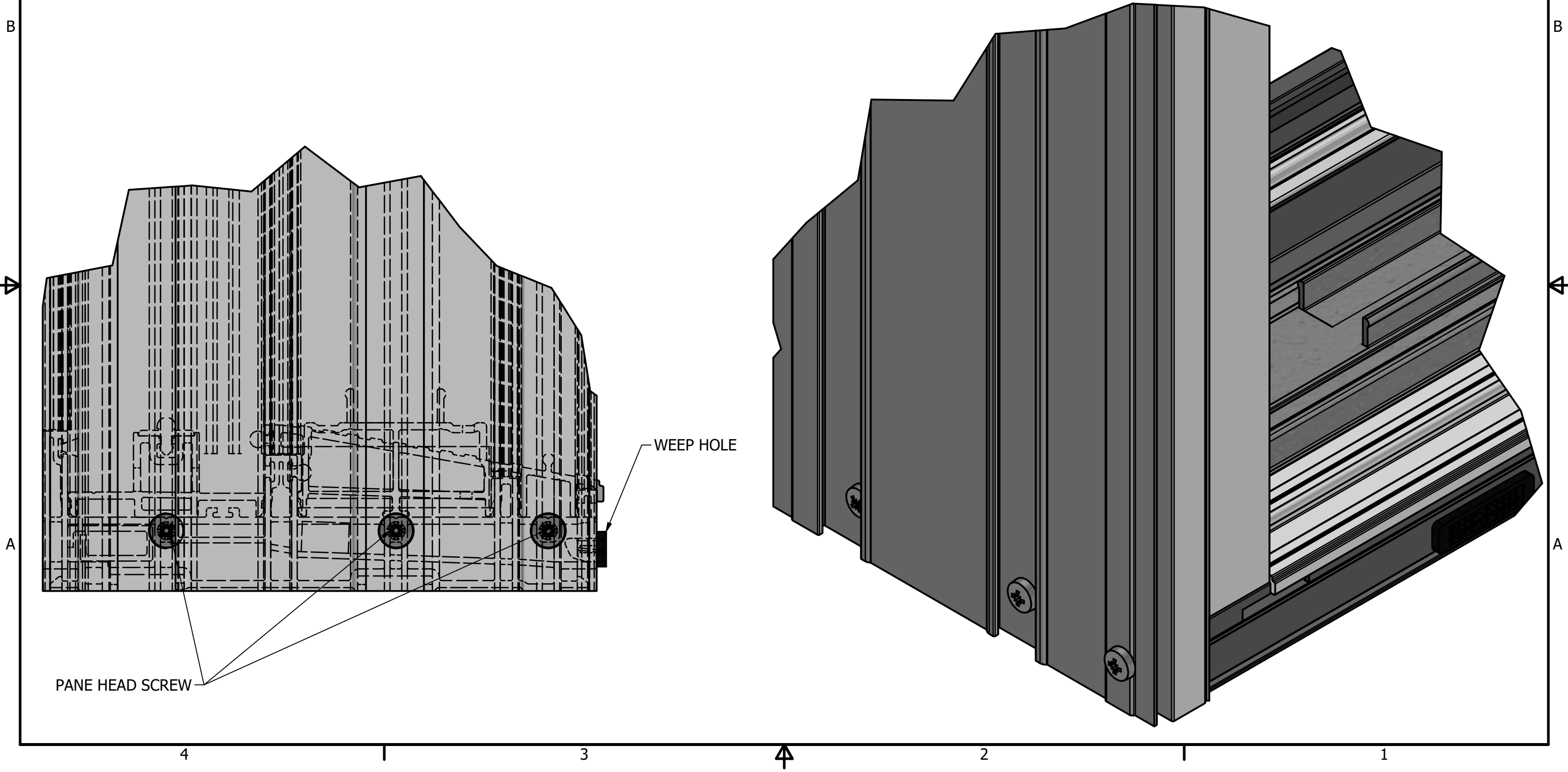

TOOLS REQUIRED:
POWER DRILL, FRAME SCREWS

3.) JOIN THE REMAINING 3 CORNERS OF THE FRAME ASSEMBLY.
ENSURE TIGHT FIT BETWEEN FRAME COMPONENTS WITH MINIMAL GAP

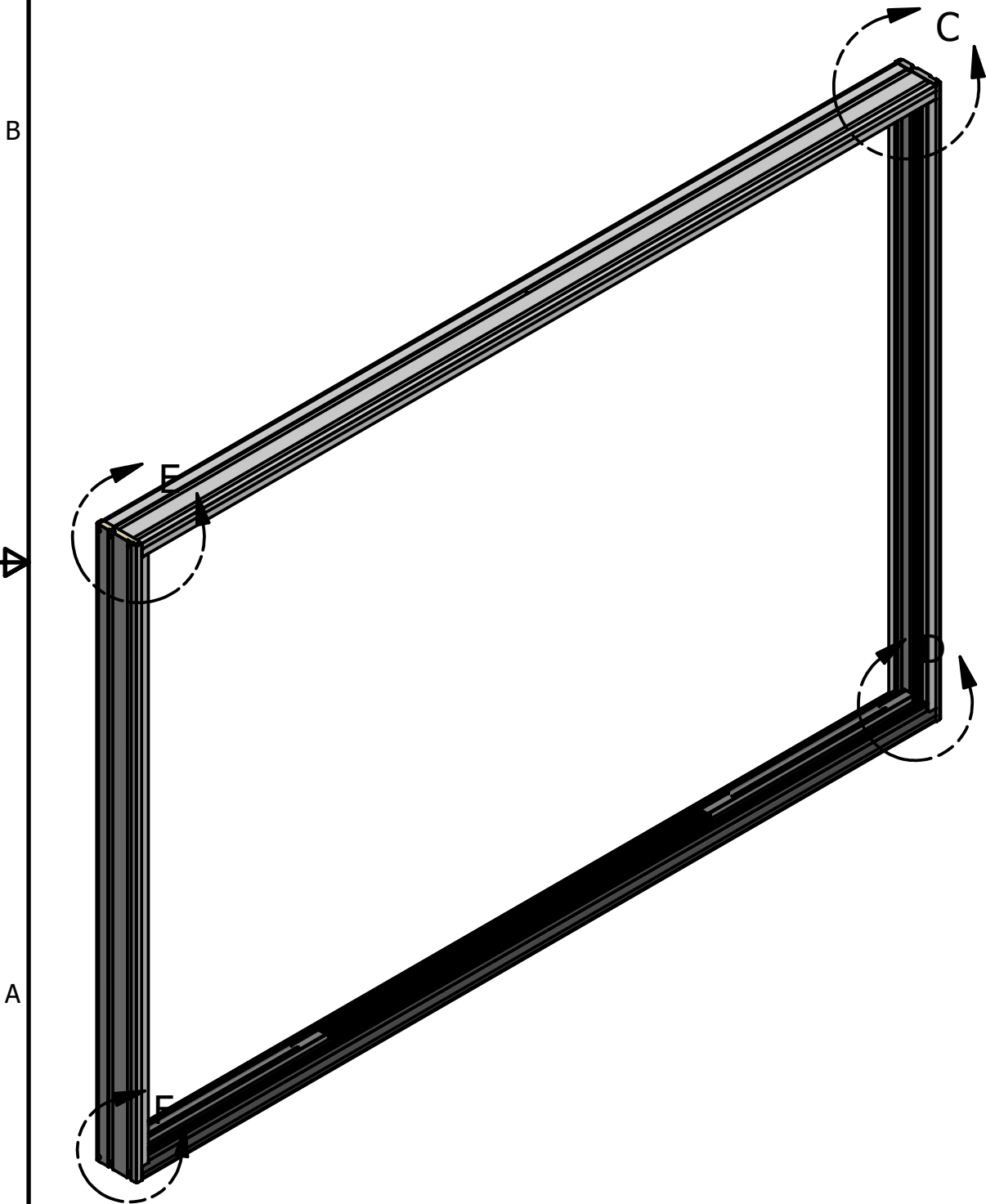

HEAD-LEFT

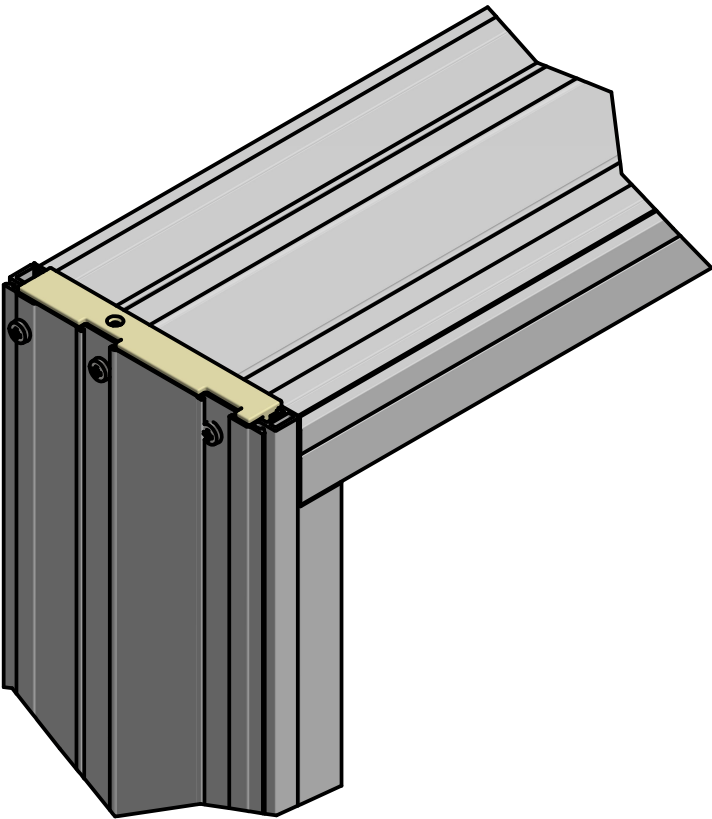

HEAD-RIGHT

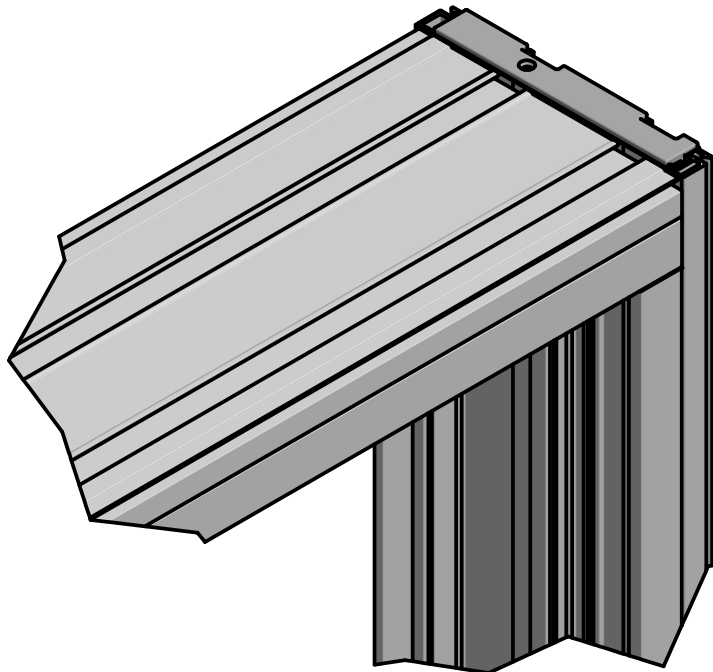

SILL-LEFT

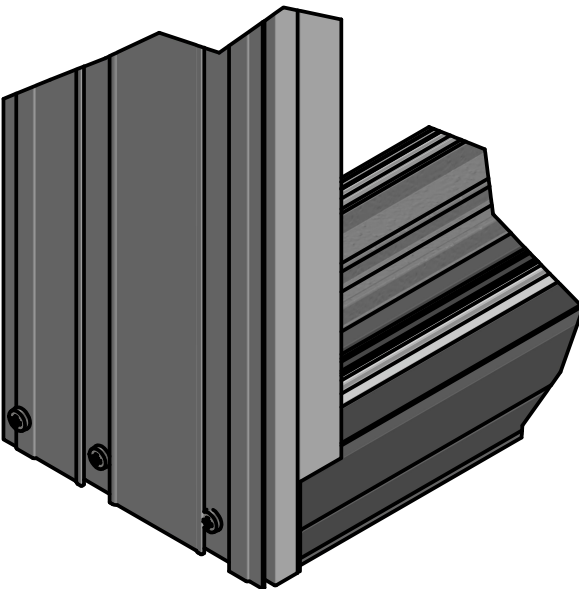

SILL-RIGHT

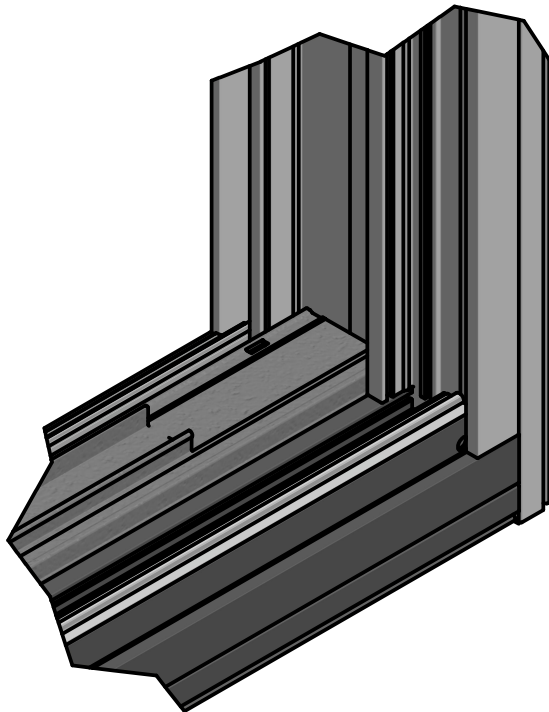

NORTH STAR HAS TWO APPROVED METHODS TO ANCHOR THE FRAME INTO THE
ROUGH OPENING

METHOD 1: ANCHORING THROUGH THE FRAME JAMBS AND HEAD; OR
METHOD 2: ANCHORING USING INSTALLATION CLIPS AT THE JAMB AND
HEAD

IMPORTANT NOTES:
NORTH STAR WINDOW AND PATIO DOOR PRODUCT MUST BE SECURED THROUGH THE
FRAME OF THE UNIT YOU ORDERED OR USING THE EXTERIOR MOUNTED STEEL CLIPS.

INSTALLATION THROUGH THE NAIL FIN ONLY IS NOT A FULL INSTALLATION. FAILURE
TO PROPERLY INSTALL CAN RESULT IN WATER DAMAGE AND SEVER MOVEMENT OF
THE UNIT OVER TIME AND WILL VOID WARRANTY.

DO NOT ANCHOR DOOR THROUGH THE JAMB EXTENSION

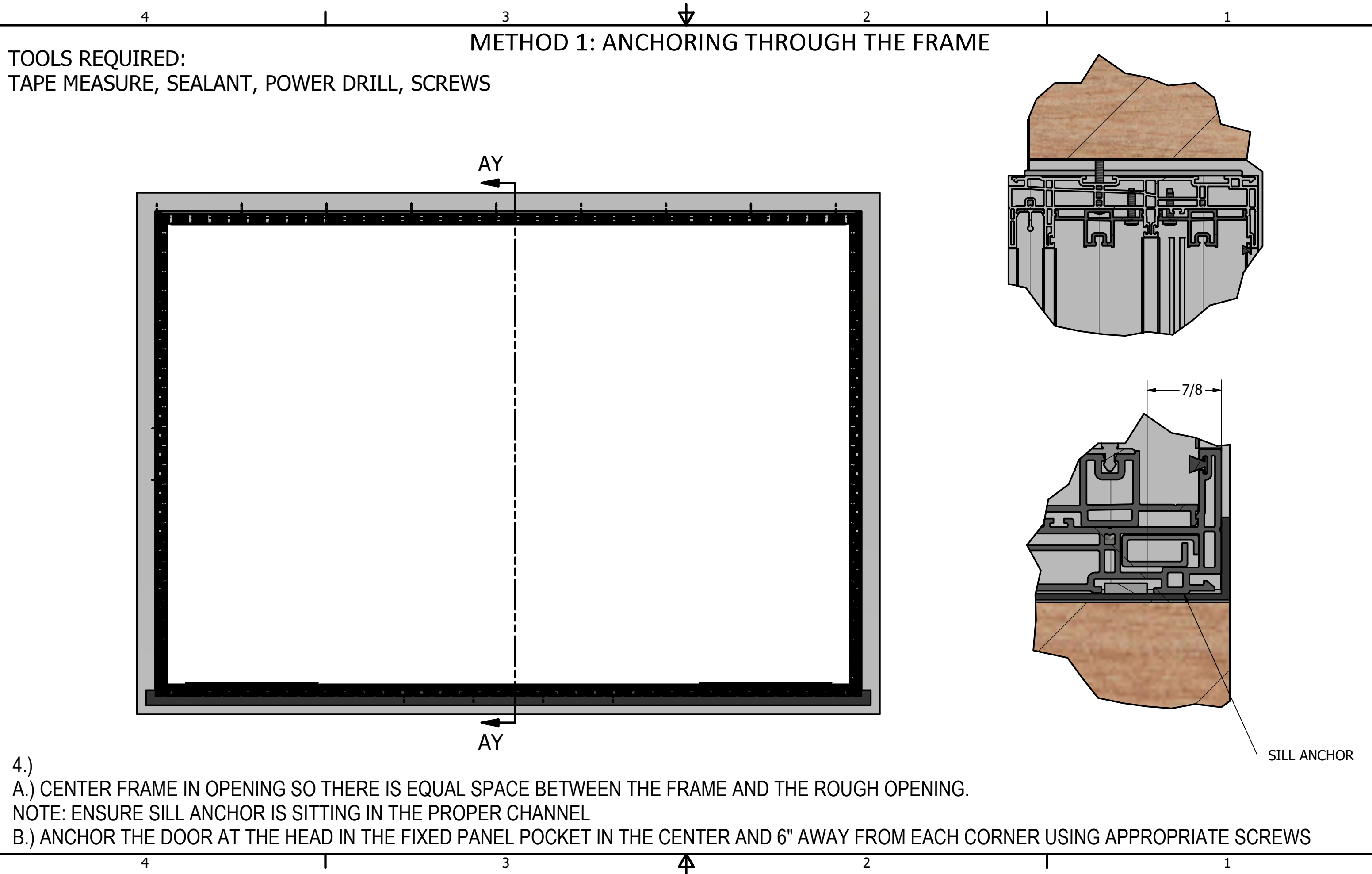

TOOLS REQUIRED:
SHIMS, TAPE MEASURE, SEALANT, POWER
DRILL, SCREWS

METHOD 1: ANCHORING THROUGH THE FRAME

SHIM LOCATION FROM CORNER

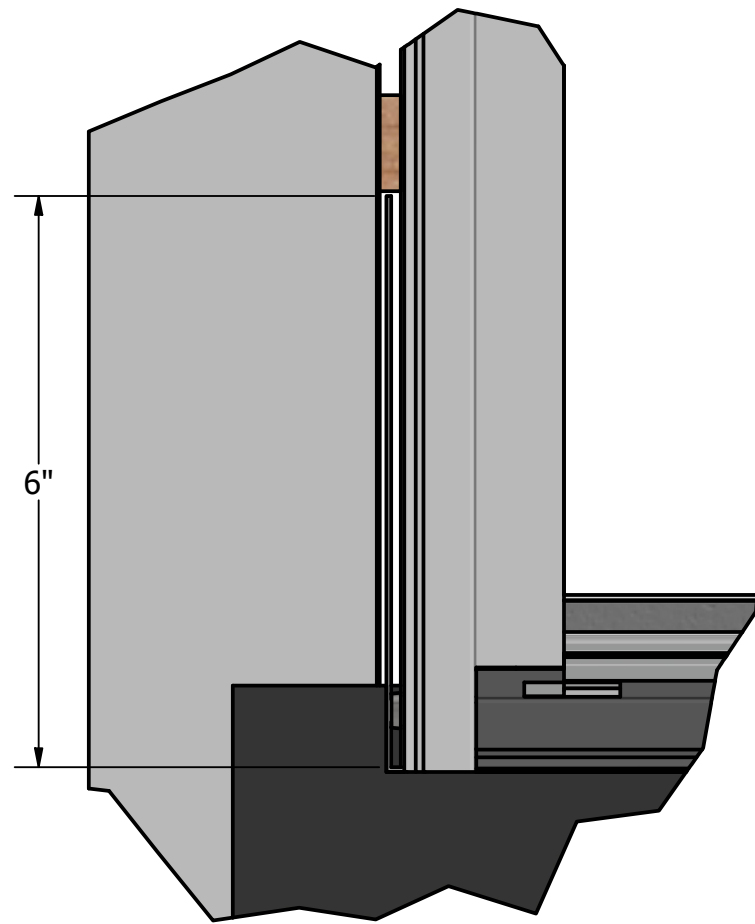

JAMB

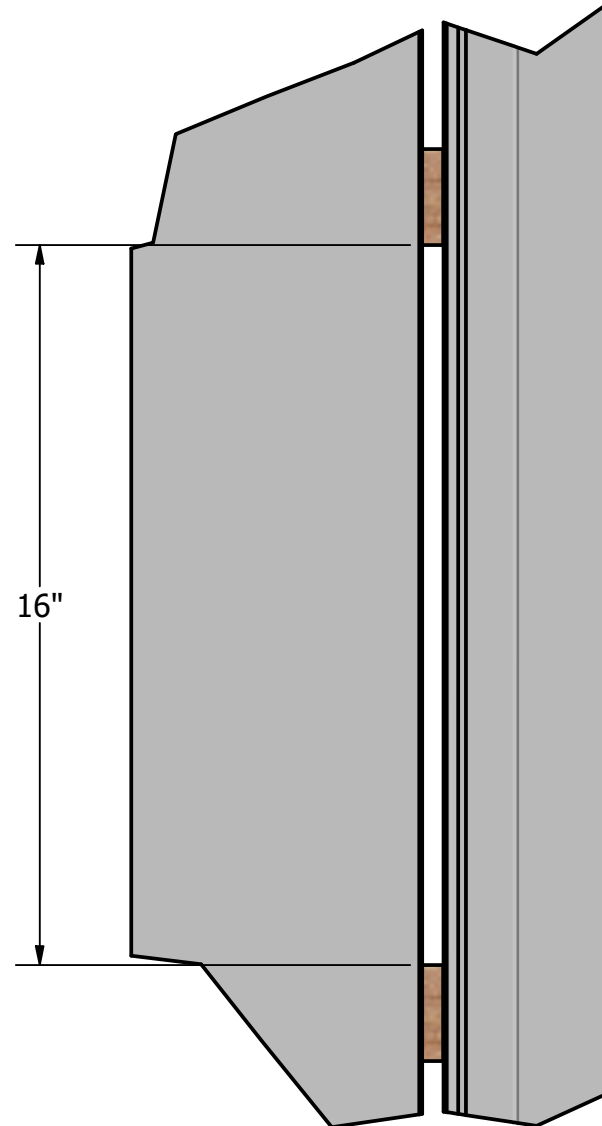

5.) SHIM SIDE JAMB FRAME MEMBERS 6" FROM TOP AND
BOTTOM.

6.) SHIM FIXED JAMB ASSEMBLY AND OPERATING JAMB
ASSEMBLY AT 16" INTERVALS .

SHIMS SHOULD BE FIRM BUT NOT TIGHT ENOUGH TO
CAUSE THE JAMBS TO BOW. CHECK THAT THE FRAME IS
LEVEL, PLUMB, AND SQUARE; ADJUST SHIMS IF
NECESSARY.

NO SHIMS AT
THE HEAD
ONLY
FASTENERS

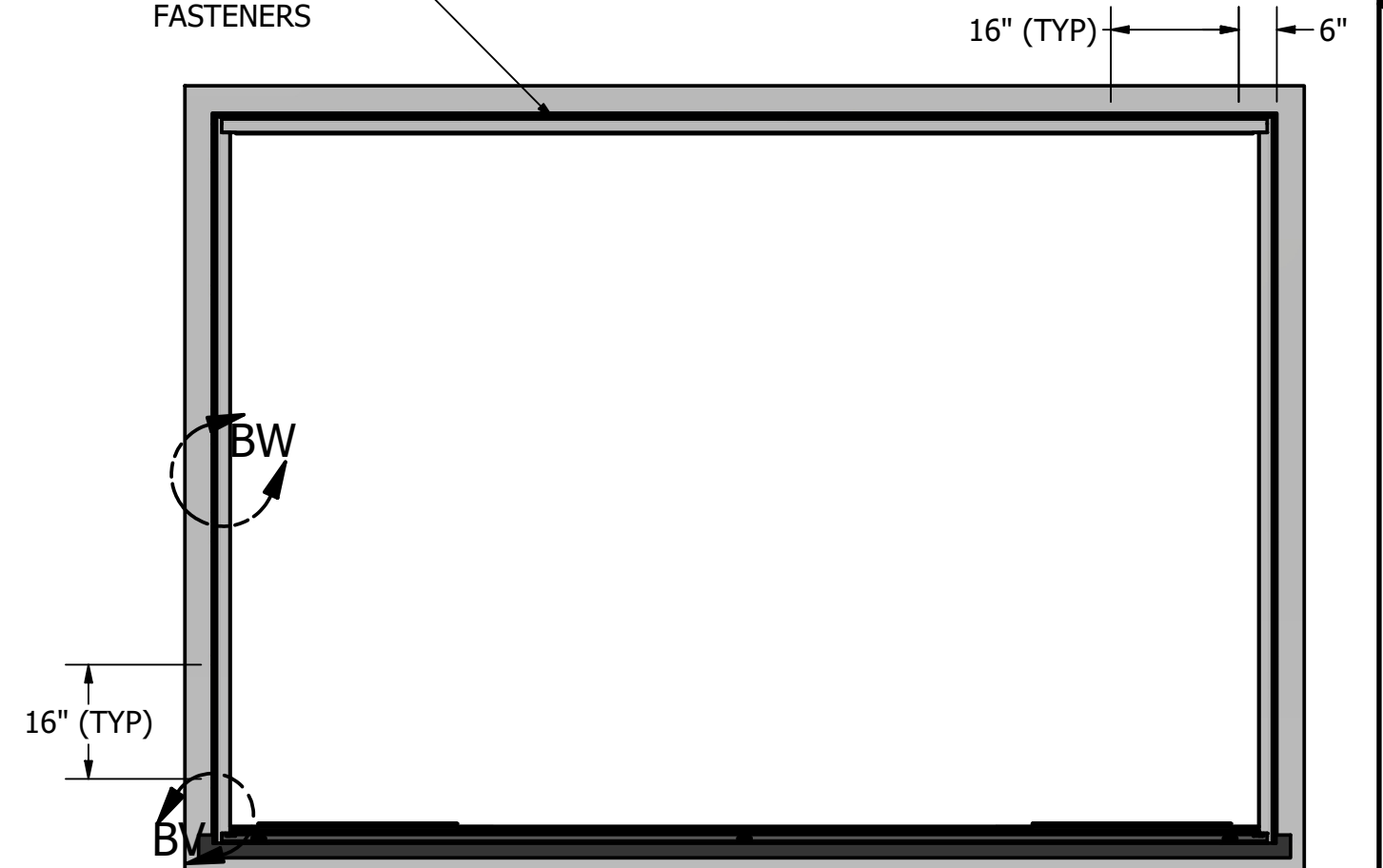

TOOLS REQUIRED:
SHIMS, SEALANT,
POWER DRILL,
SCREWS, LEVEL

METHOD 1: ANCHORING THROUGH THE FRAME

NOTE: REMOVE POCKET COVERS AS NEEDED

7.) INSTALL SCREWS THROUGH THE FRAME WHERE POCKET COVERS WILL BE INSTALLED AT EACH SHIM LOCATION, BEING CAREFUL NOT TO BOW FRAME. USE #8 X 2-1/2" SCREWS. SCREW LENGTH IS DEPENDENT UPON FRAME STRUCTURE; SCREW LENGTH MUST BE OF SUFFICIENT LENGTH TO SECURE UNIT IN OPENING (MINIMUM OF 1" PENETRATION THROUGH THE JAMB IS REQUIRED)

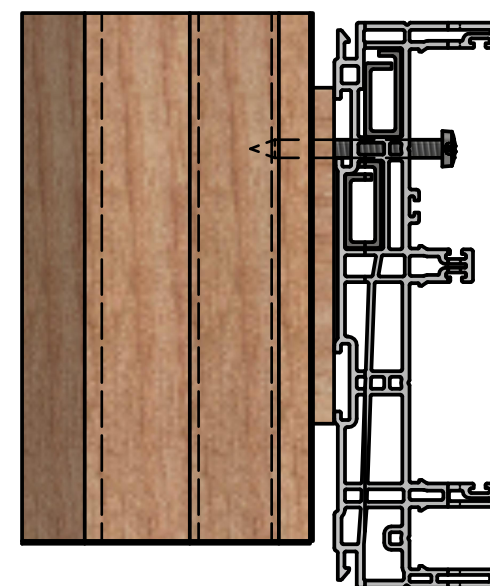

8.) INSTALL SCREWS THROUGH THE HEAD JAMB INTO THROUGH OPENING AT 16" INTERVALS
9.) SEAL SCREW HEADS WITH SILICONE.

TOOL REQUIRED:
SEALANT

10.) APPLY SEALANT TO BOTH SUPPORT BLOCK AS SHOWN IN THE DIAGRAM,
DO NOT BLOCK DRAIN HOLES.

SILL ASSEMBLY

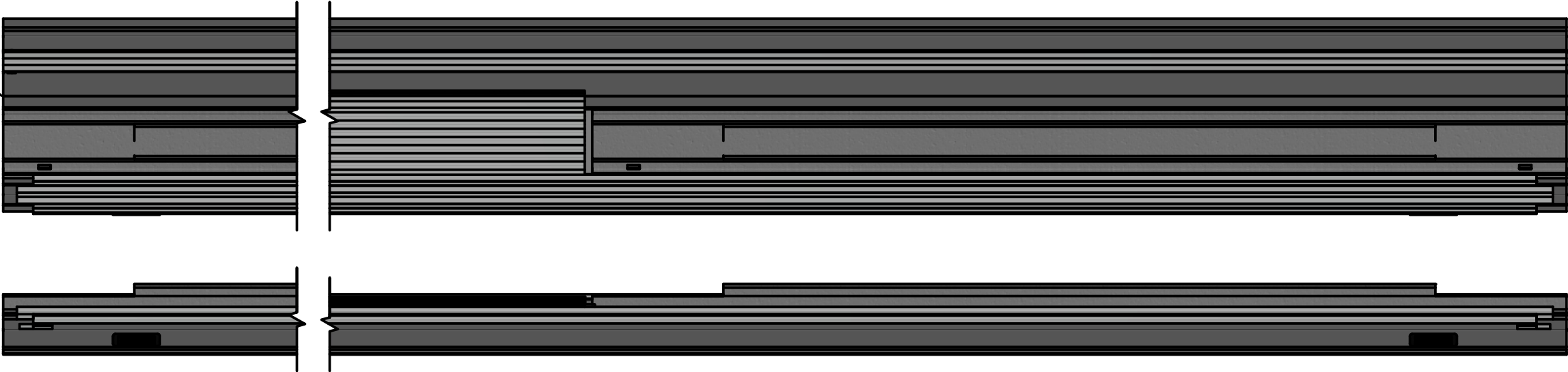

INTERIOR

SEALANT

DRAIN HOLES

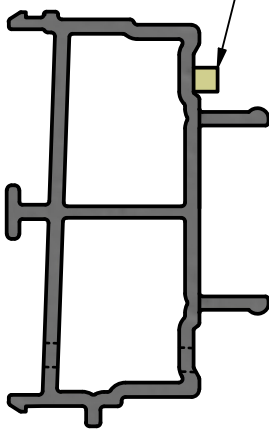

EXTERIOR

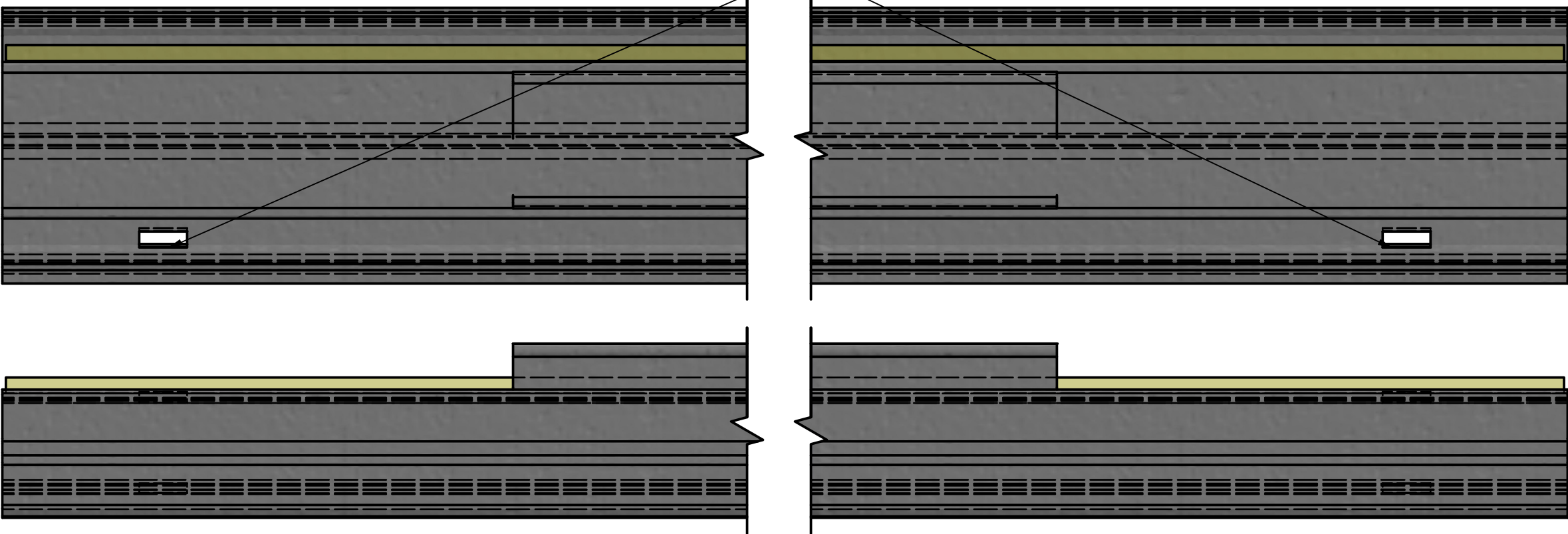

TOOL REQUIRED:
POWER DRILL, SASH
SCREWS

11.) SLIDE THE FIXED SASH OVER THE SLOPPED SILL COVER AND OVER THE SUPPORT BLOCK INTO THE FIXED JAMB ASSEMBLY POCKET

12.) ANCHOR THE SASH TO THE FIXED JAMB ASSEMBLY USING #6 x 3/4" FH SCREWS PROVIDED THROUGH THE OPERATING CHANNEL ON THE FIXED JAMB ASSEMBLY

13.) ANCHOR THE HEAD THROUGH THE W/S ADAPTER USING SCREW PROVIDED

-REPEAT STEP 11-13 FOR THE OTHER FIXED SASH

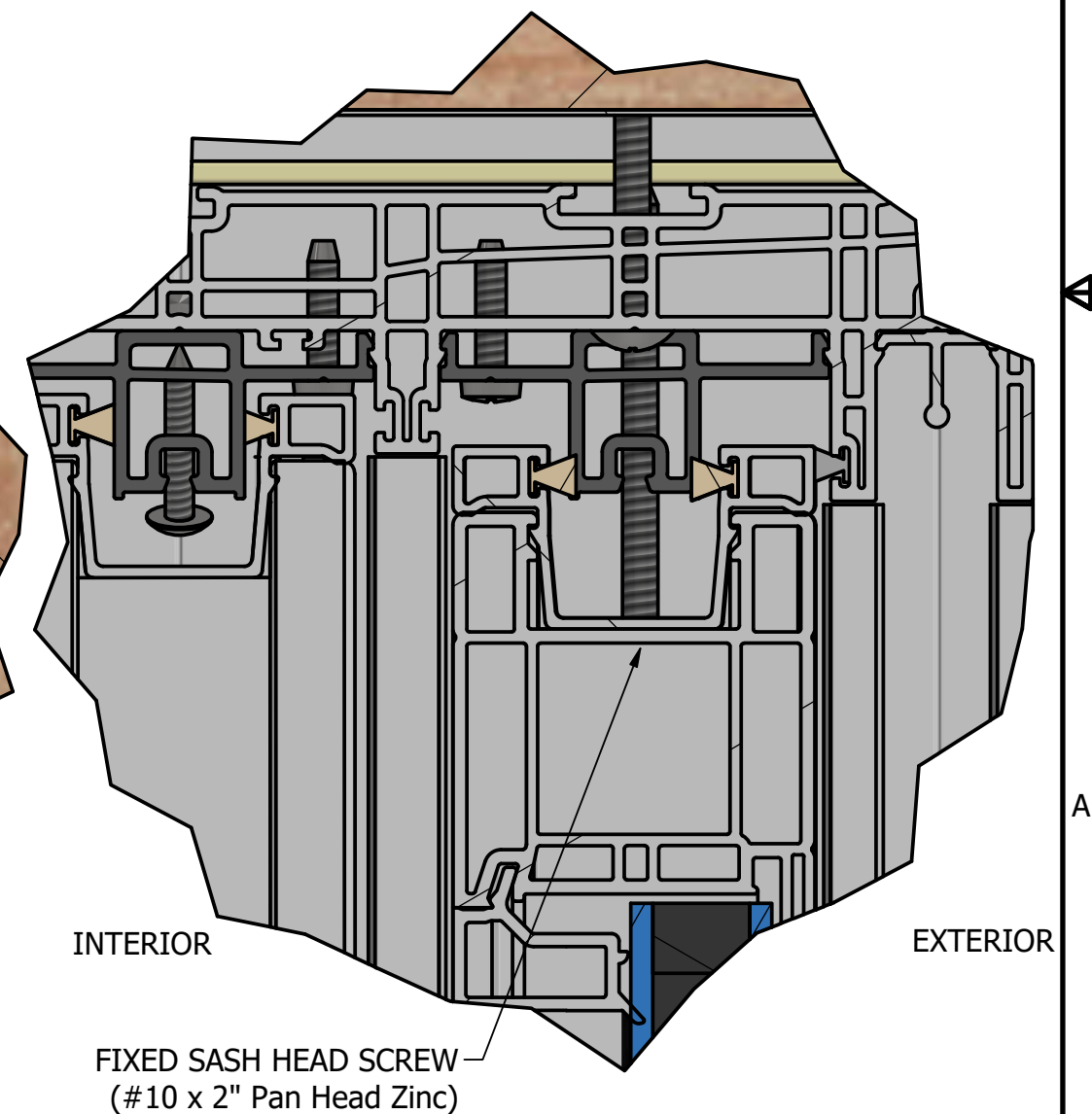
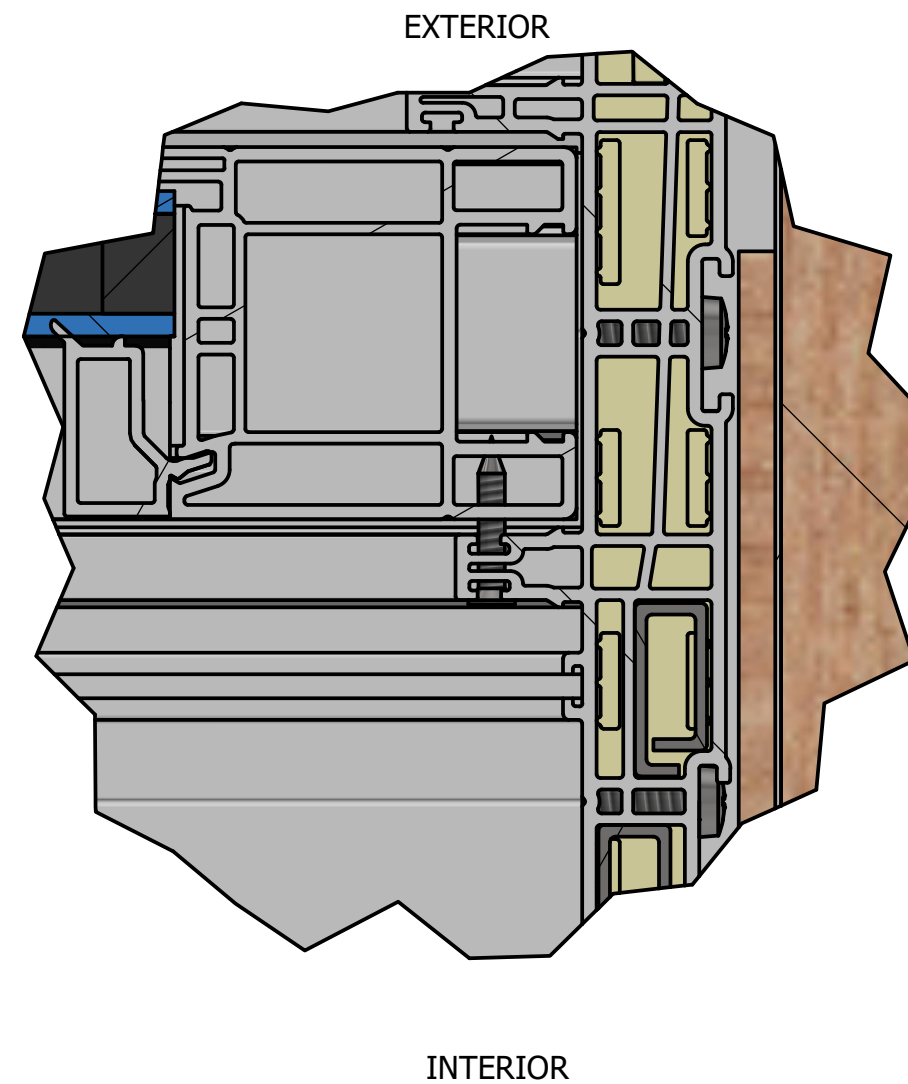
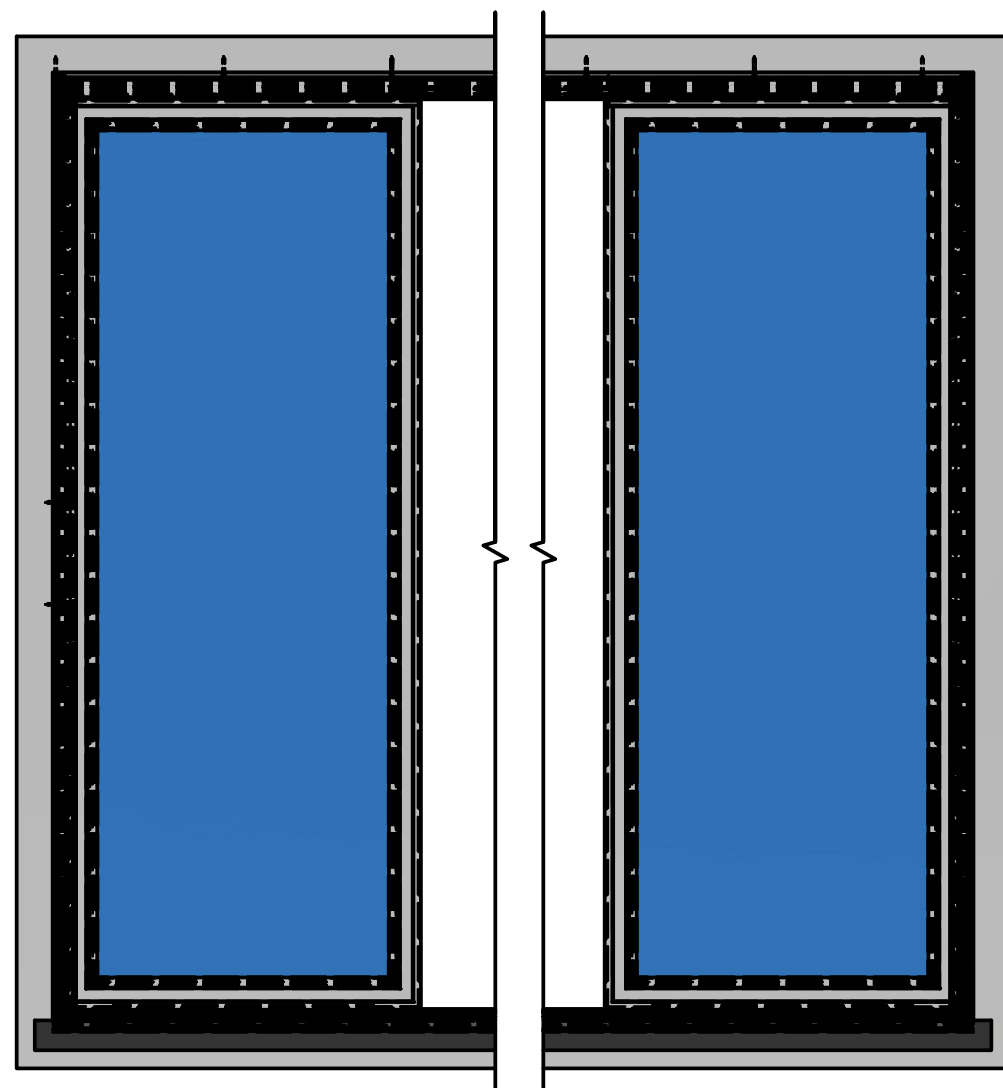

4 1 3 2 1

TOOL REQUIRED:
PRY BAR, POWER DRILL, 1/2"X 16" WOOD BLOCK, MALLET

HEAD
ASSEMBLY

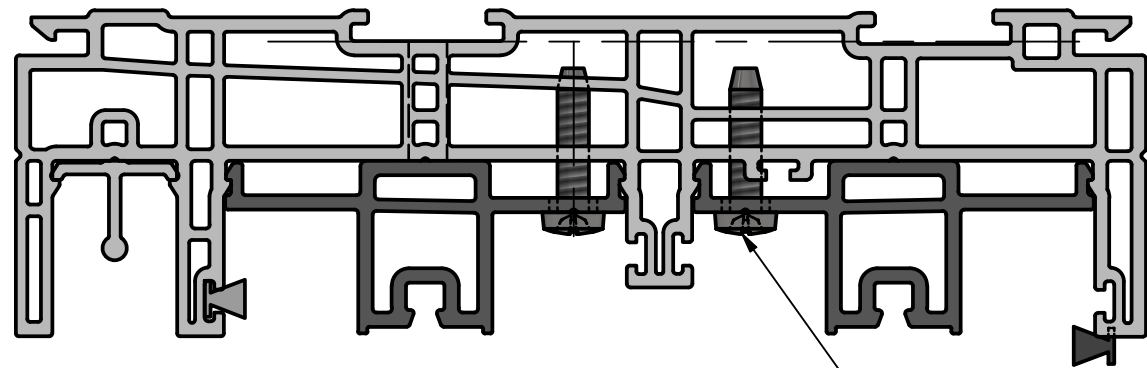

DO NOT THROW

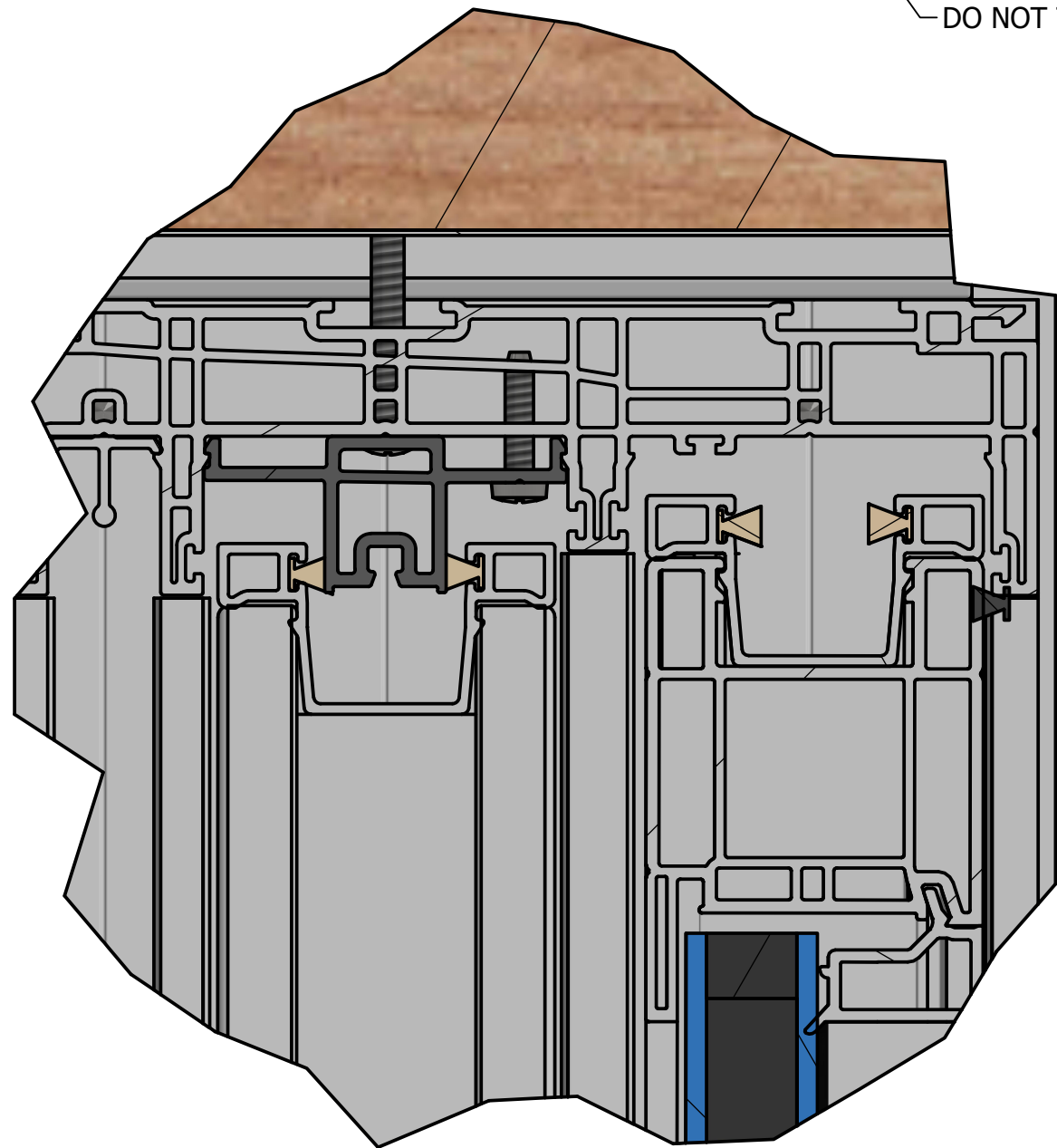

- 14.) REMOVE THE TRACK IN THE OPERATING CHANNEL (DO NOT DISCARD THE SCREWS)
- 15.) SLIDE THE OPERATING PANEL FROM THE INTERIOR INTO THE FRAME CHANNEL. ENSURE ROLLERS ARE CONTACTING SILL TRACK
- 16.)RE-INSERT THE HEAD TRACK INTO THE HEAD CHANNEL AND SCREW IT IN. SLIDE THE SASH AS REQUIRED TO FASTEN THE SCREWS BACK

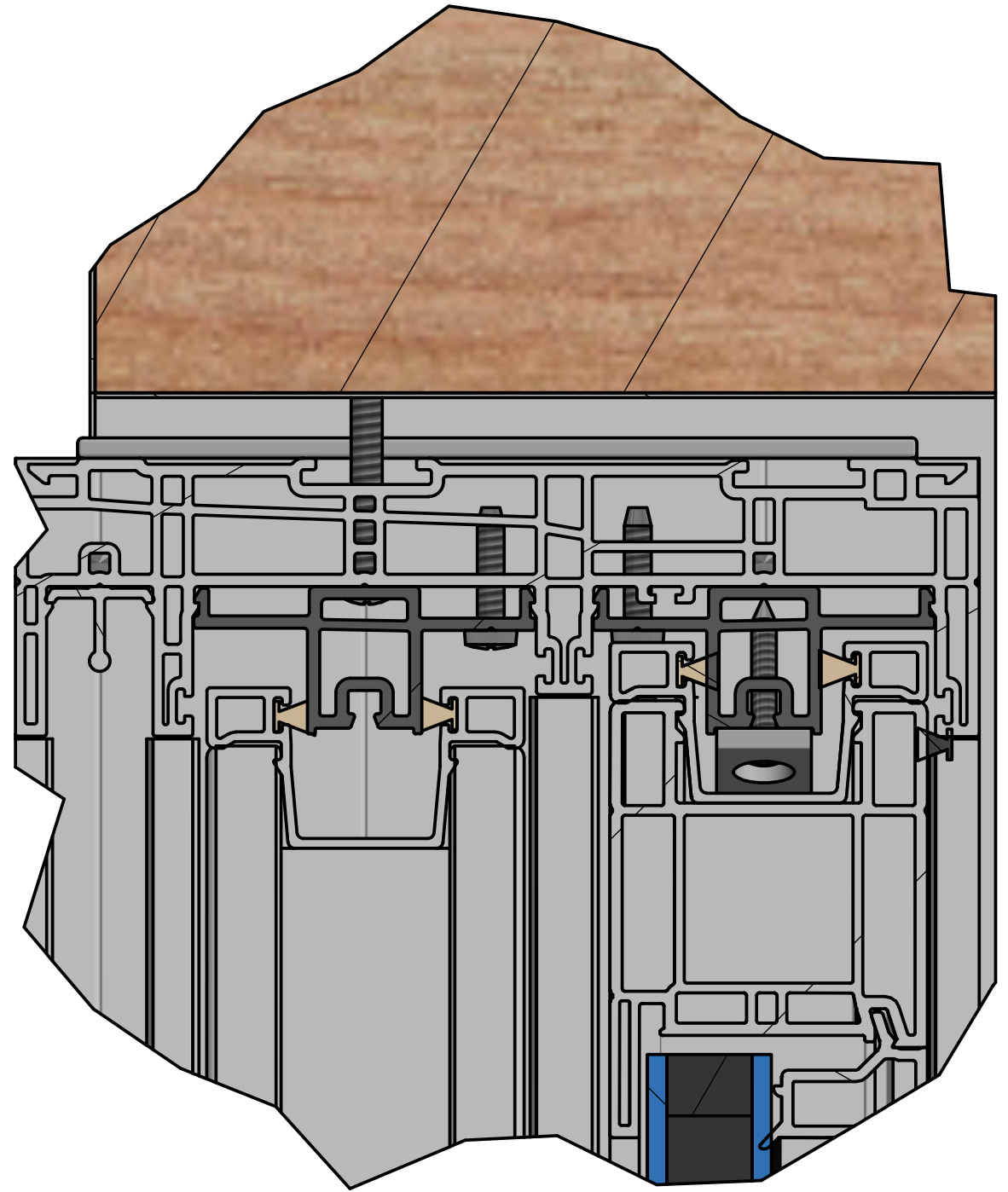

TOOLS REQUIRED:
POWER DRILL, ANTI-LIFT BLOCK SCREW

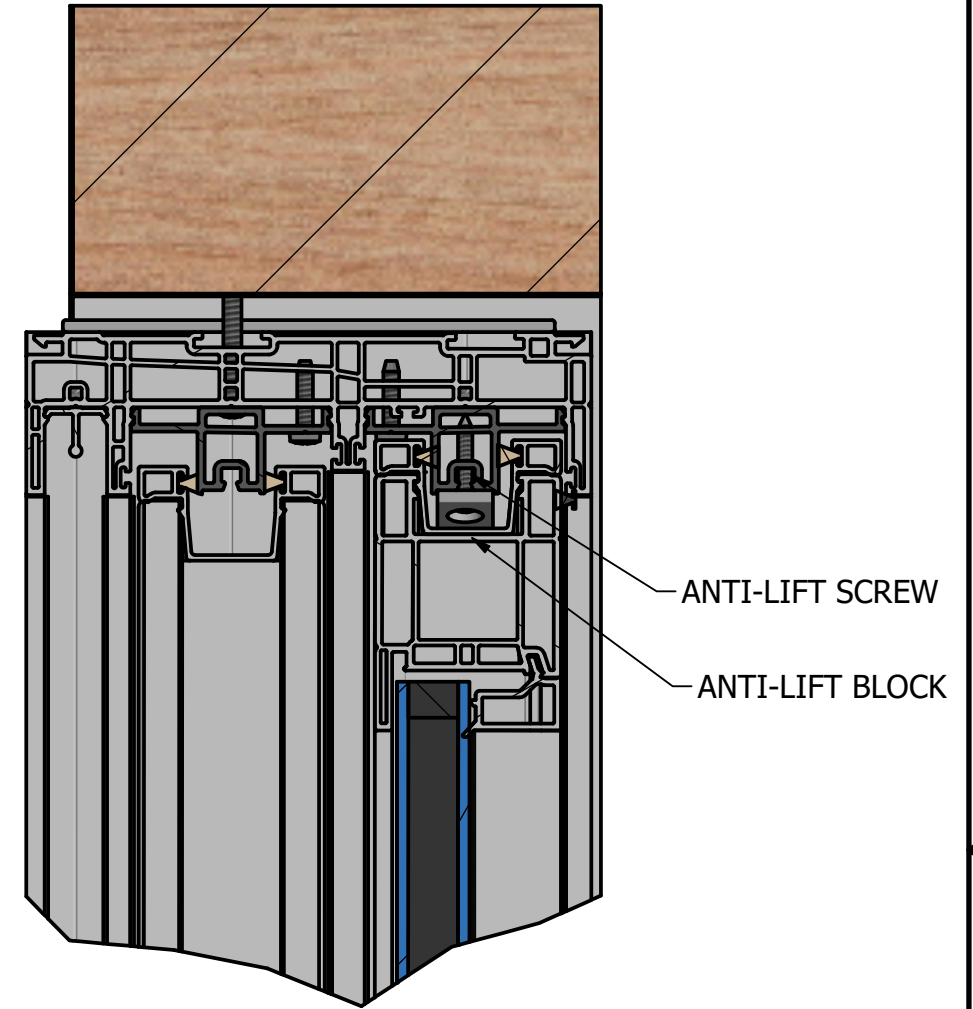
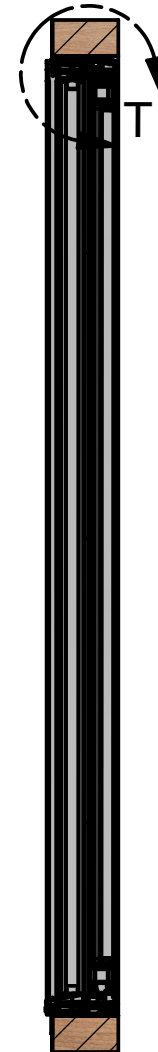
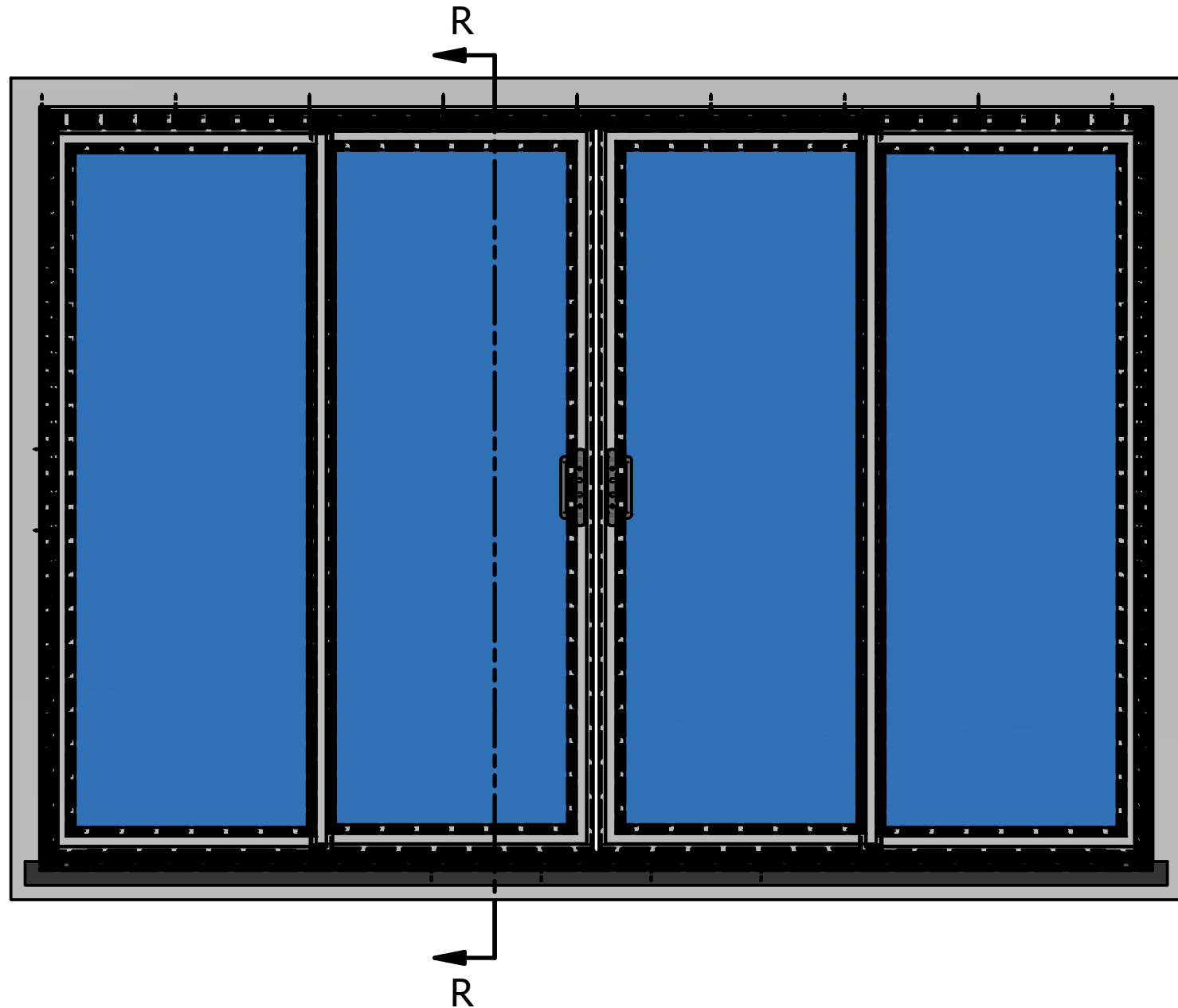

DETAIL T
SCALE 1 / 2

17.) INSTALL ANTI-LIFT BLOCK.
THE BLOCK SHOULD BE FLUSH WITH THE SASH END
IN LOCKED POSITION.
THIS WILL ENSURE THAT THE INTERLOCK DOES NOT
INTERFERE IN THE OPERATION

TOOLS REQUIRED:
SEALANT

18.) SLIDE OPERATING PANEL INTO A CLOSED POSITION AND
INSTALL FIXED SASH INTERLOCK.
SEAL THE BOTTOM OF THE INTERLOCK TO THE SILL TOWER
WITH HIGH QUALITY SEALANT

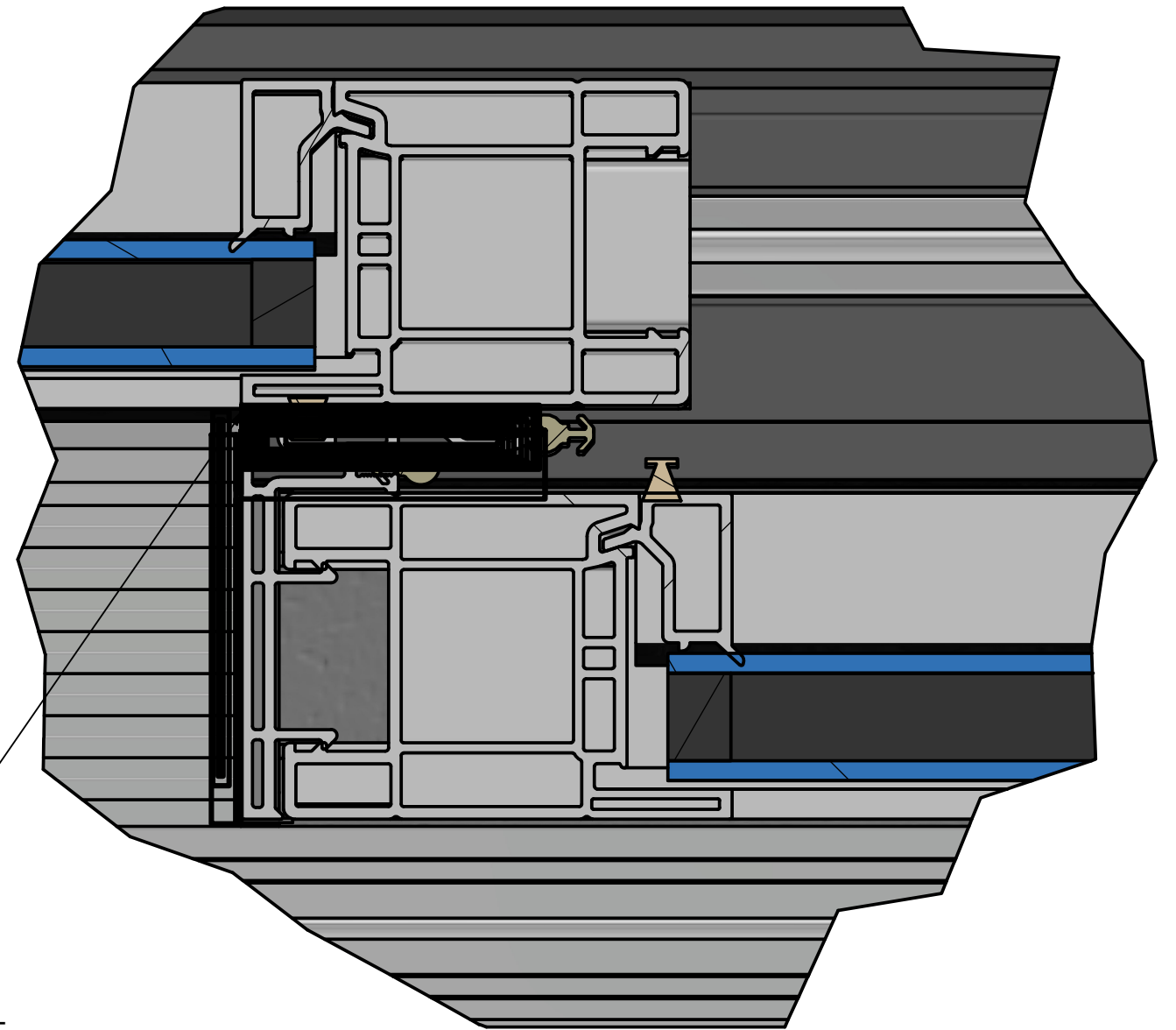
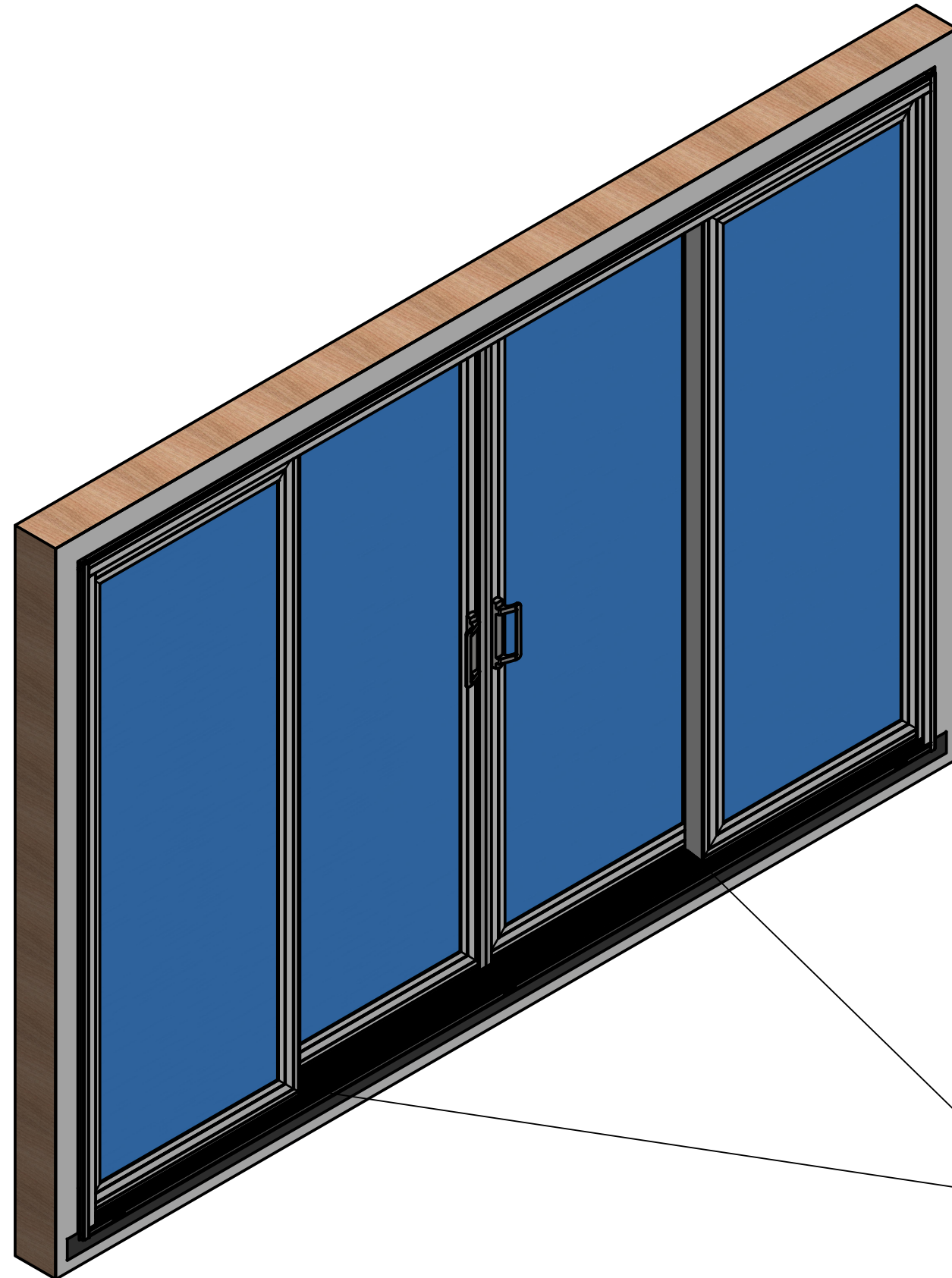

SEALANT
LOCATION

TOOLS REQUIRED:
MALLET

- 19.) INSTALL OPERATING SASH INTERLOCK
20.) INSTALL OPERATING JAMB POCKET COVERS
21.) INSTALL 4-PANEL MULLION & FASTEN WITH OXXO SCREWS

CHECK ALIGNMENT BETWEEN THE TWO SASHES INTERLOCK
SHOULD BE FLUSH WITH GLASS STOP AS SHOWN BELOW

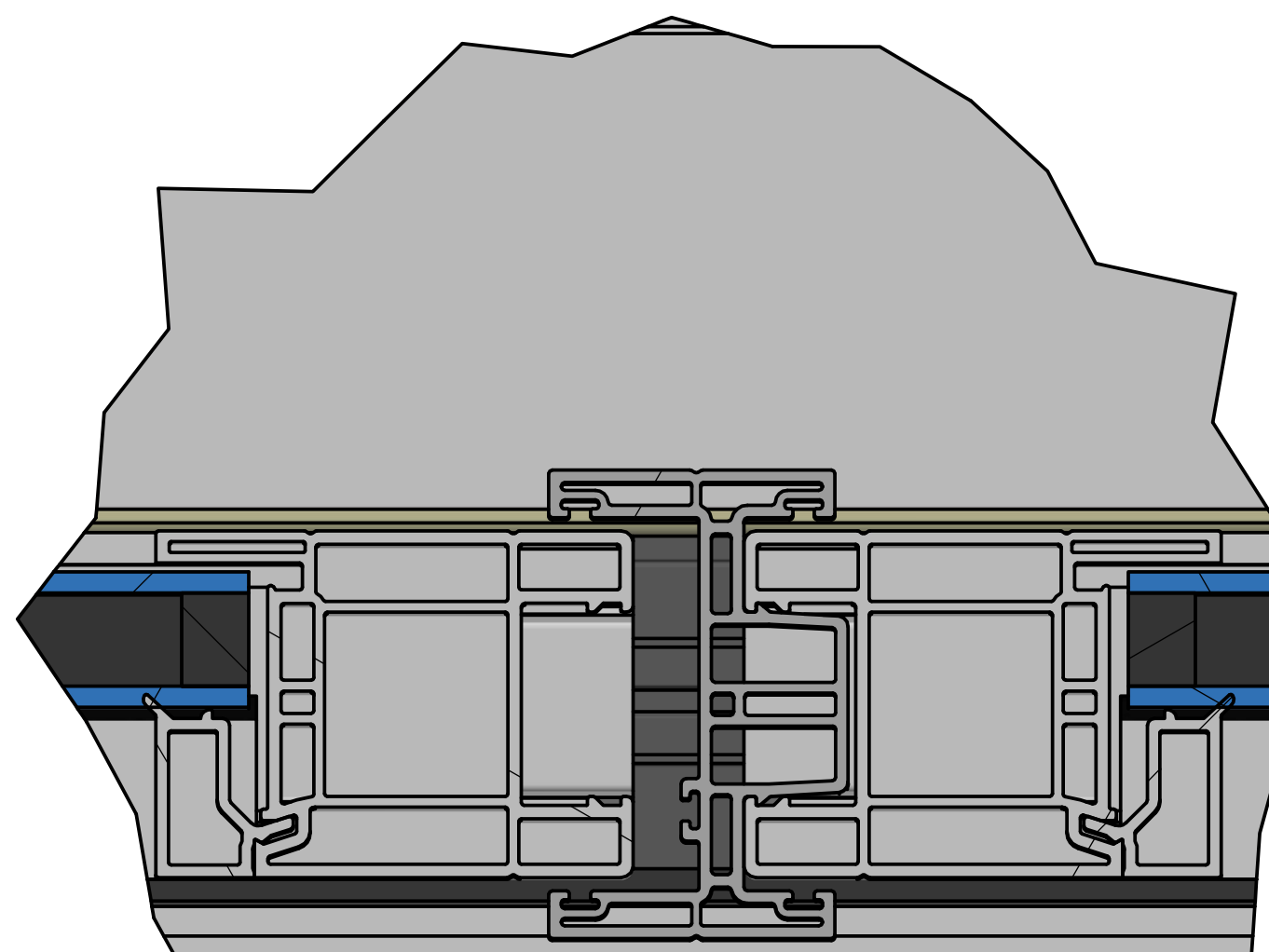
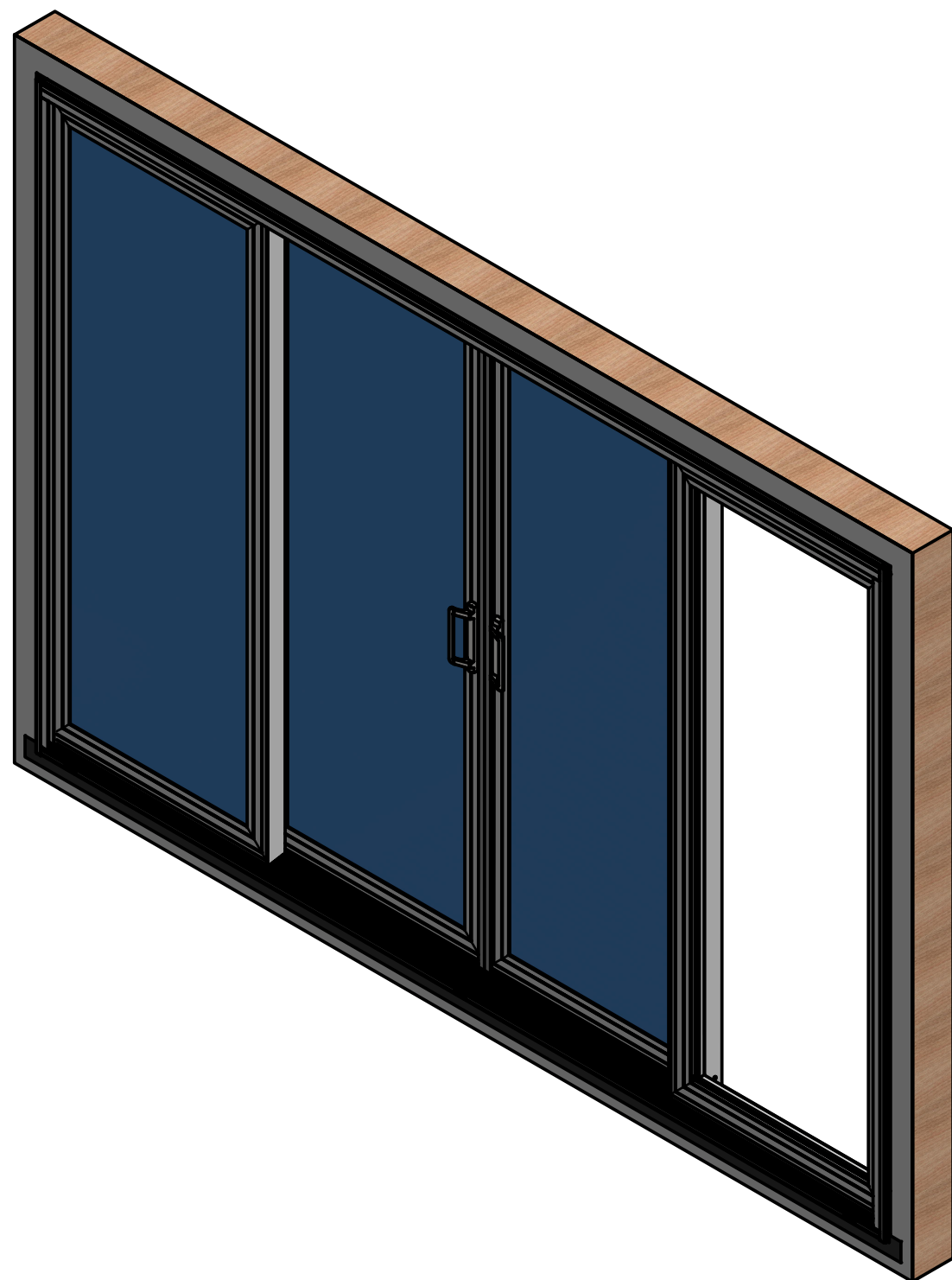

DETAIL BD
SCALE 1 : 1

TOOLS REQUIRED:
Mallet, SILICONE

22.) INSTALL HEAD JAMB POCKET COVER AND SEAL EACH END
23.) FROM THE EXTERIOR SEAL THE POCKET COVER TO THE SLOPPED SILL COVER ENDS

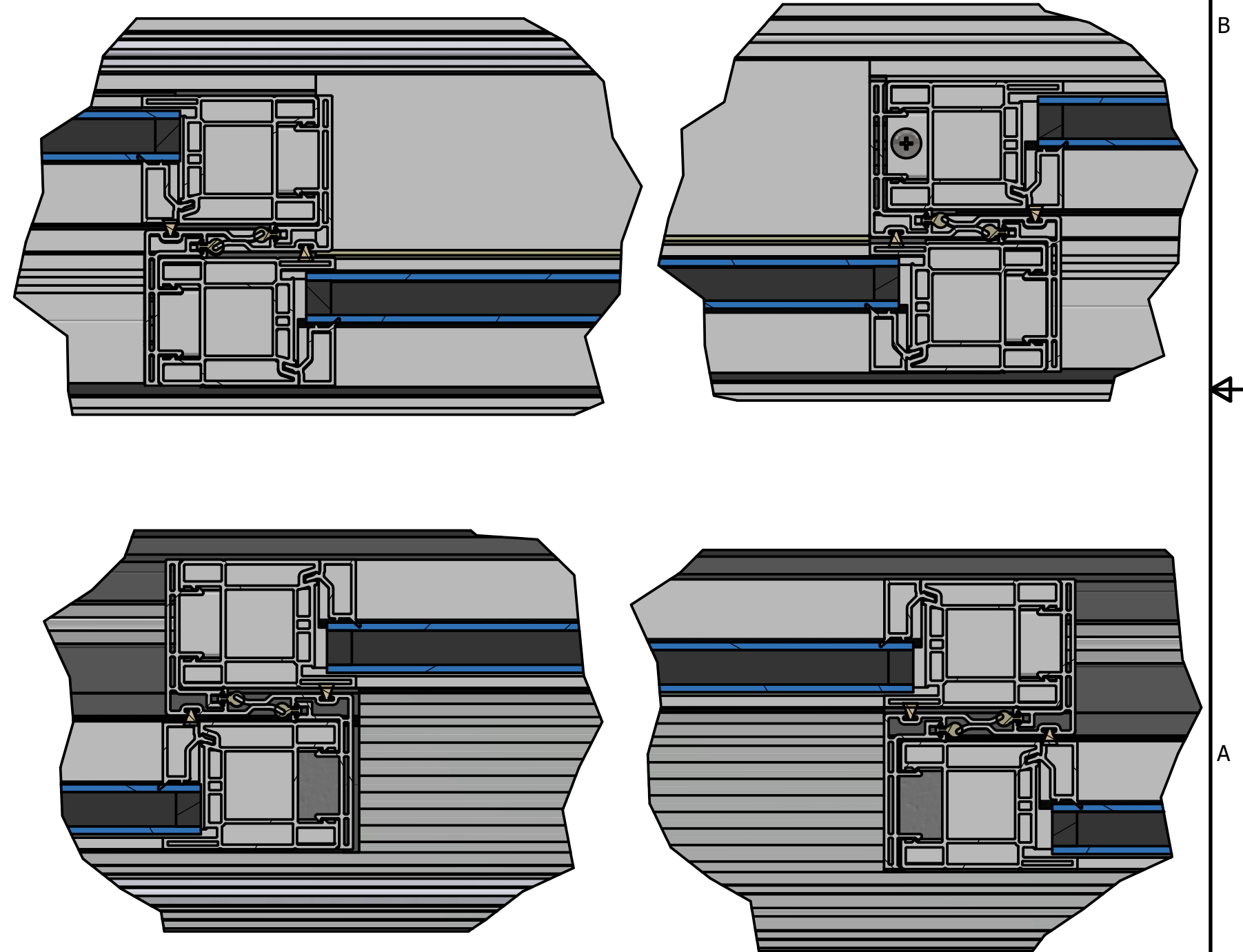
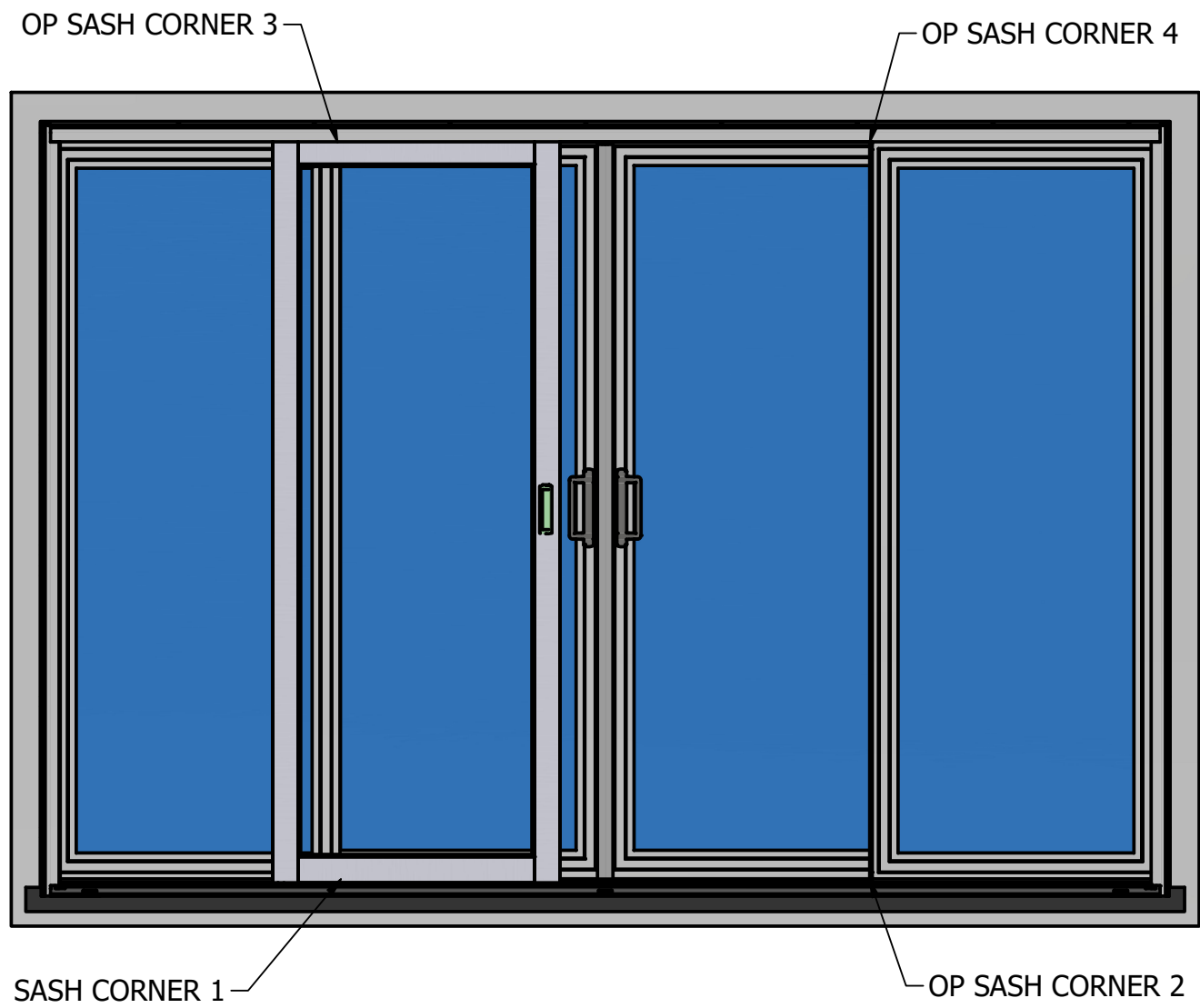

TOOLS REQUIRED:
BACKER ROD, SPRAY FOAM INSULATION
UTILITY KNIFE

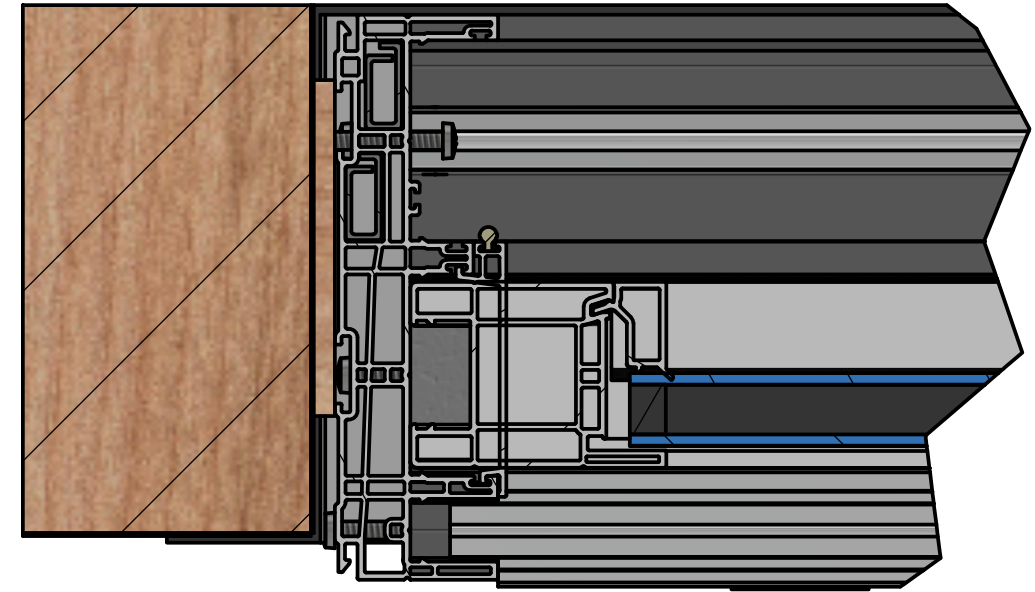
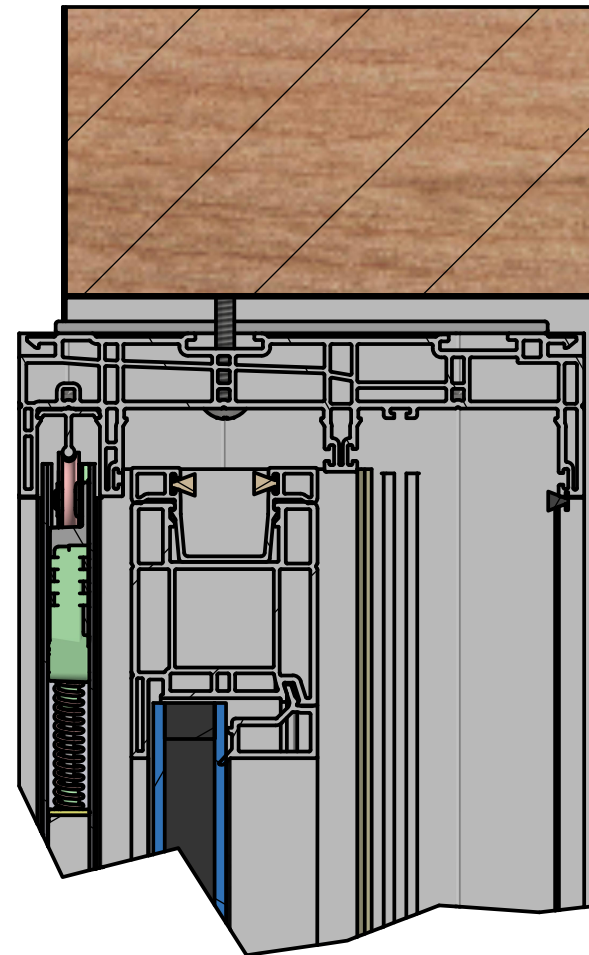
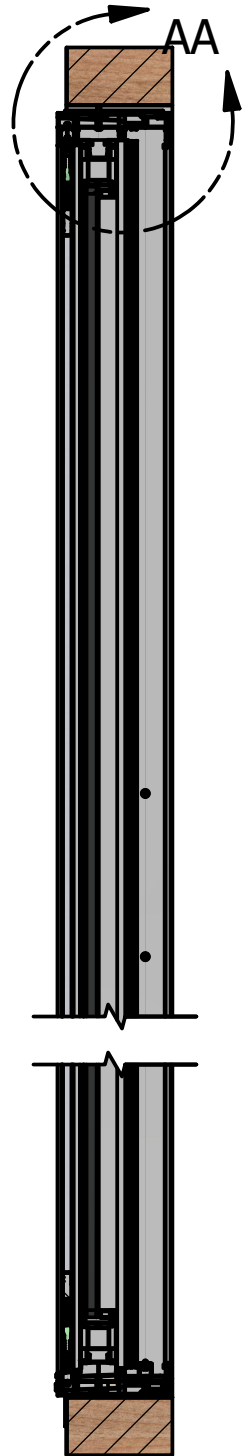

24.) FROM THE EXTERIOR INSTALL BACKER RODS AROUND THE DOOR JAMBS AND HEAD. USE THE APPROPRIATE SIZE ENSURING AT LEAST 25% BACKER ROD COMPRESSION.

25.) INSULATE BETWEEN THE DOOR FRAME AND THE ROUGH OPENING, ENSURING ALL VOIDS ARE FILLED. CAUTION MUST BE EXERCISED NOT TO OVER PACK THE INSULATION CAUSING UNIT FRAME TO DISTORT.

26.) SEAL AND TRIM DOOR INSIDE AND OUT TO SUIT APPLICATION.

27.)INSTALL AND ADJUST SCREEN DOOR

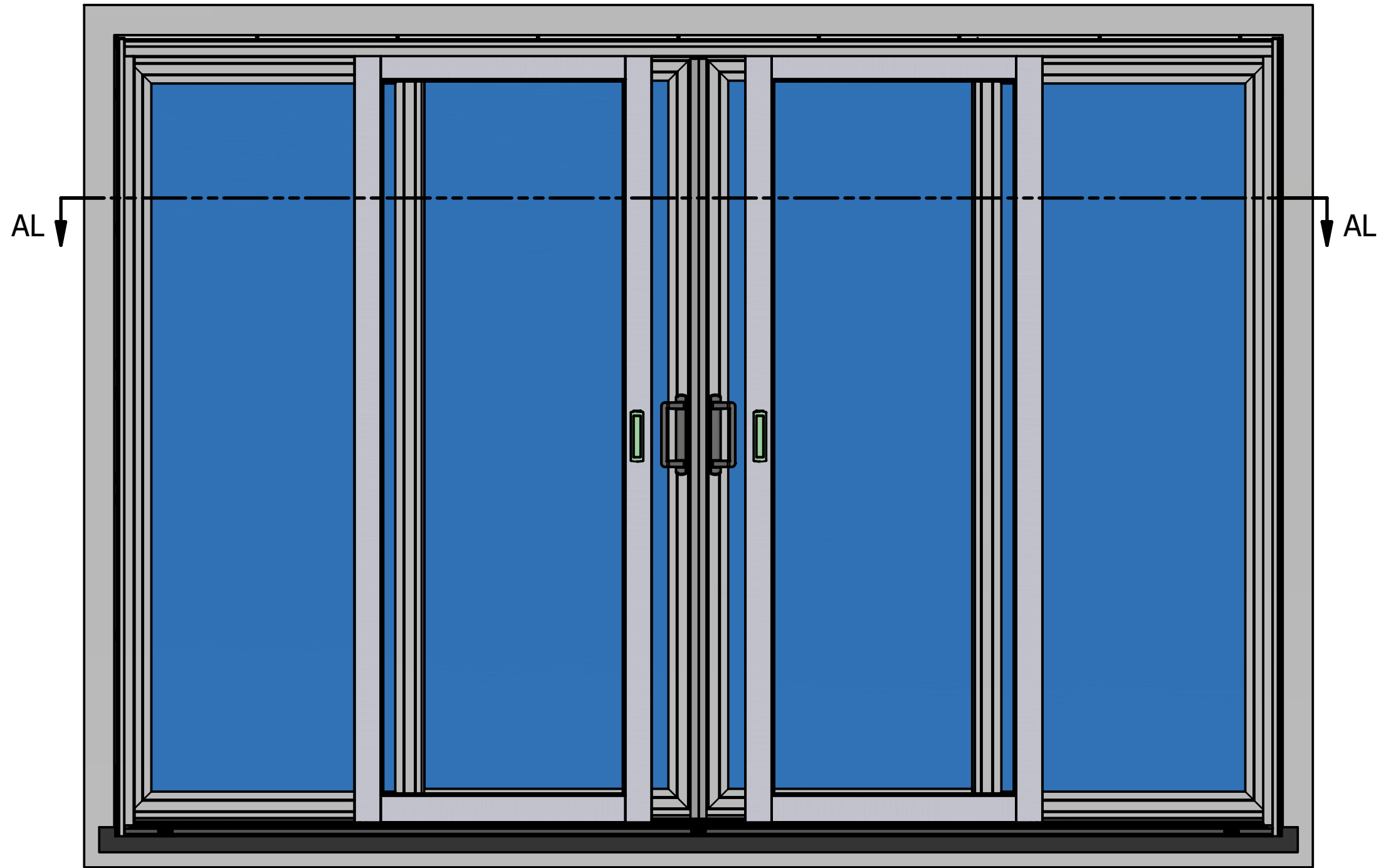

METHOD 2: USING INSTALLATION CLIPS

5.)

A) PLACE THE GALVANIZED STEEL ANCHOR CLIPS 6" IN FROM EACH CORNER AND THEN AT APPROXIMATELY 16" INTERVALS AT THE JAMBS AND AT THE HEAD

B.) CENTER THE FRAME IN OPENING SO THERE IS EQUAL SPACE BETWEEN THE FRAME AND THE ROUGH OPENING.
NOTE: ENSURE SILL ANCHOR IS SITTING IN THE PROPER LOCATION.

C.) ANCHOR THE DOOR AT THE HEAD IN THE FIXED PANEL POCKET CENTERED 6" AWAY FROM EACH CORNER USING #8 1-1/2" SCREWS

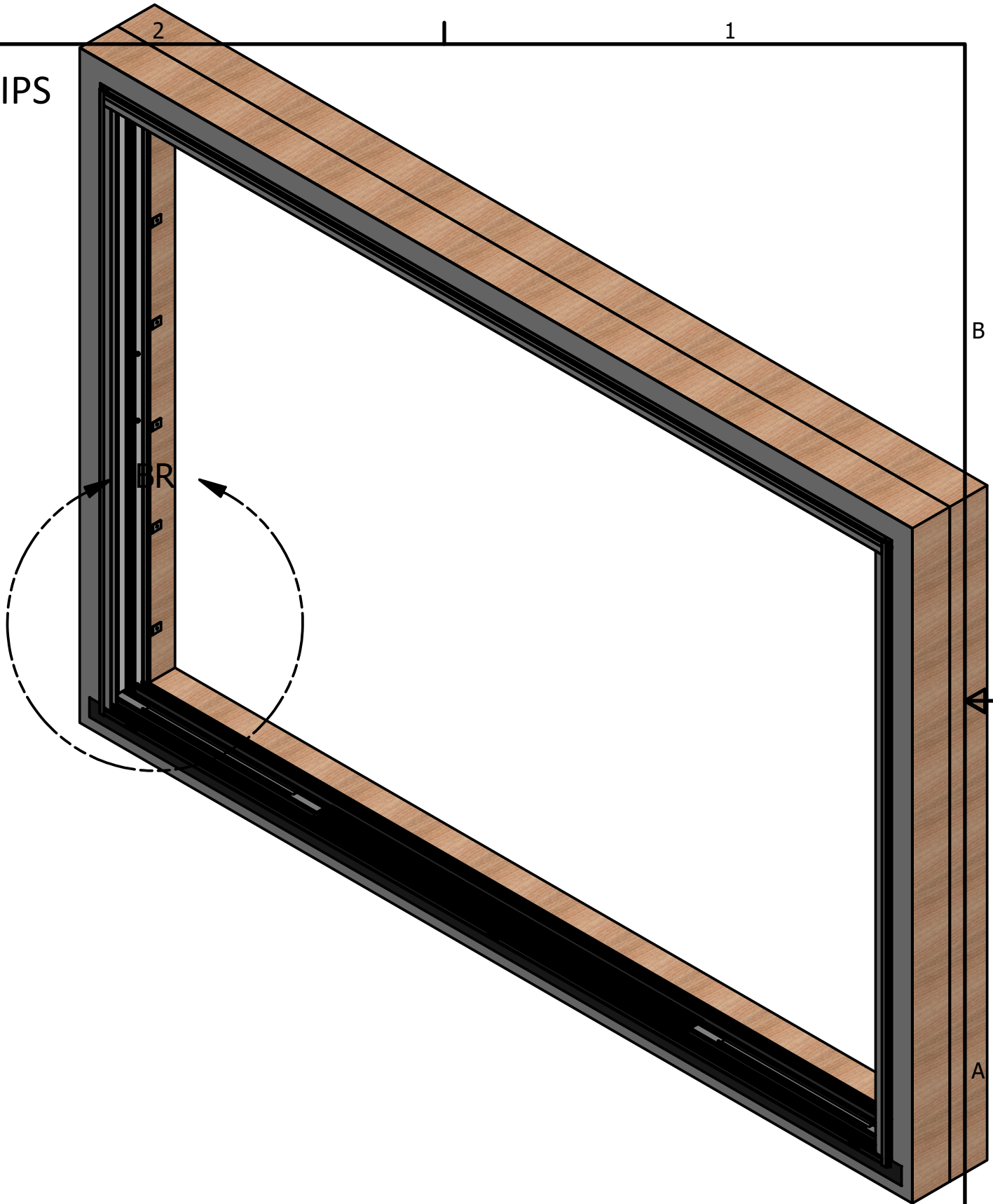
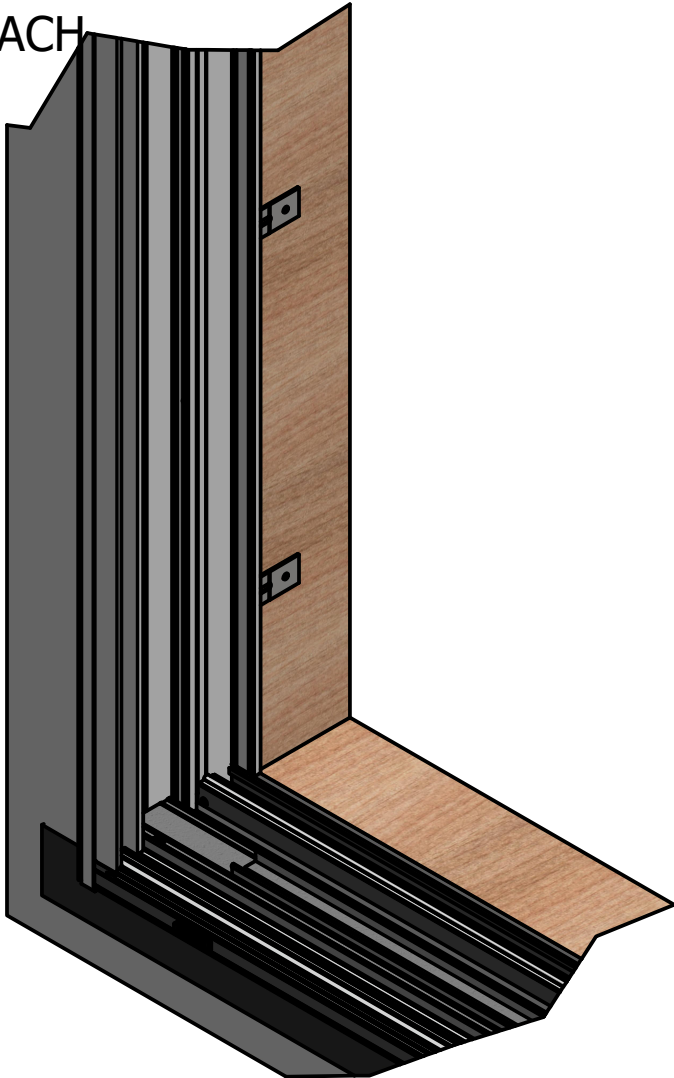
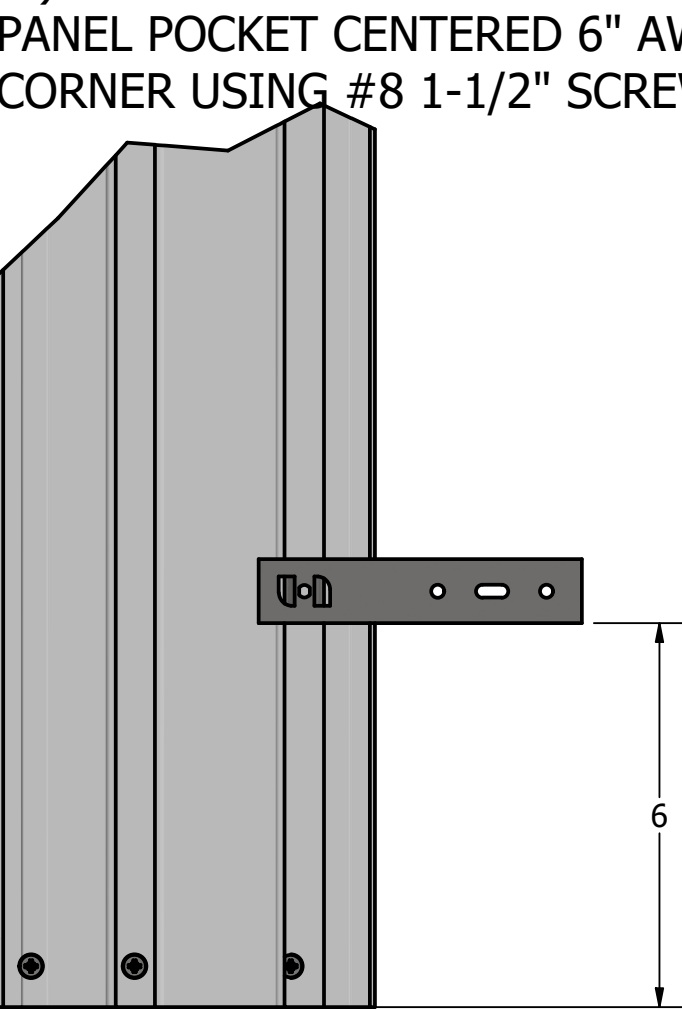

Method 2: using the installation clips

Tool Required:

Shims, Tape Measure, Sealant,
Power Drill, Screws

6.) SHIM SIDE JAMB BEHIND EACH CLIP LOCATION; SHIMS SHOULD BE FIRM BUT NOT TIGHT ENOUGH TO CAUSE THE JAMBS TO BOW. CHECK THAT THE FRAME IS LEVEL, PLUMB, AND SQUARE; ADJUST SHIMS IF NECESSARY.

NOTE: ADDITIONAL SHIMS ARE REQUIRED AT SINGLE POINT AND MULTIPOINT KEEPER SCREW LOCATIONS.

DO NOT SHIM THE HEAD

7.) INSTALL SCREWS THROUGH THE HOLES ON THE INSTALLATION CLIPS AT EACH SHIM/ CLIP LOCATION LOCATION BEING CAREFUL NOT TO BOW FRAME. SUGGEST USING #8 X 1-1/2" SCREWS. SCREW LENGTH IS DEPENDENT UPON FRAME STRUCTURE, SCREW LENGTH MUST BE OF SUFFICIENT LENGTH TO SECURELY ANCHOR UNIT IN OPENING. (MINIMUM OF 1" PENETRATION THROUGH THE JAMB IS REQUIRED)

8.) REMOVE KEEPER SCREWS AND REPLACE THEM WITH SUPPLIED SCREWS. SCREWS SHOULD RUN THROUGH THE INSTALLED SHIMS INTO THE ROUGH OPENING. IMPORTANT: WHEN ANCHORING UNIT THROUGH JAMB, SEAL SCREW HEADS WITH SILICONE.

